

PROVIDENCE, R. I.
CITY ENGINEER'S OFFICE.
STREET LINE DEPT.

Apr. 9, 1884

09810

Providence R. I.
This map accompanies
our report of this date

MAP OF
OLNEY STREET

FROM CAMP ST. TO NORTH ST.

IN TEN SHEETS

SCALE 60 FEET PER INCH

81
I-8

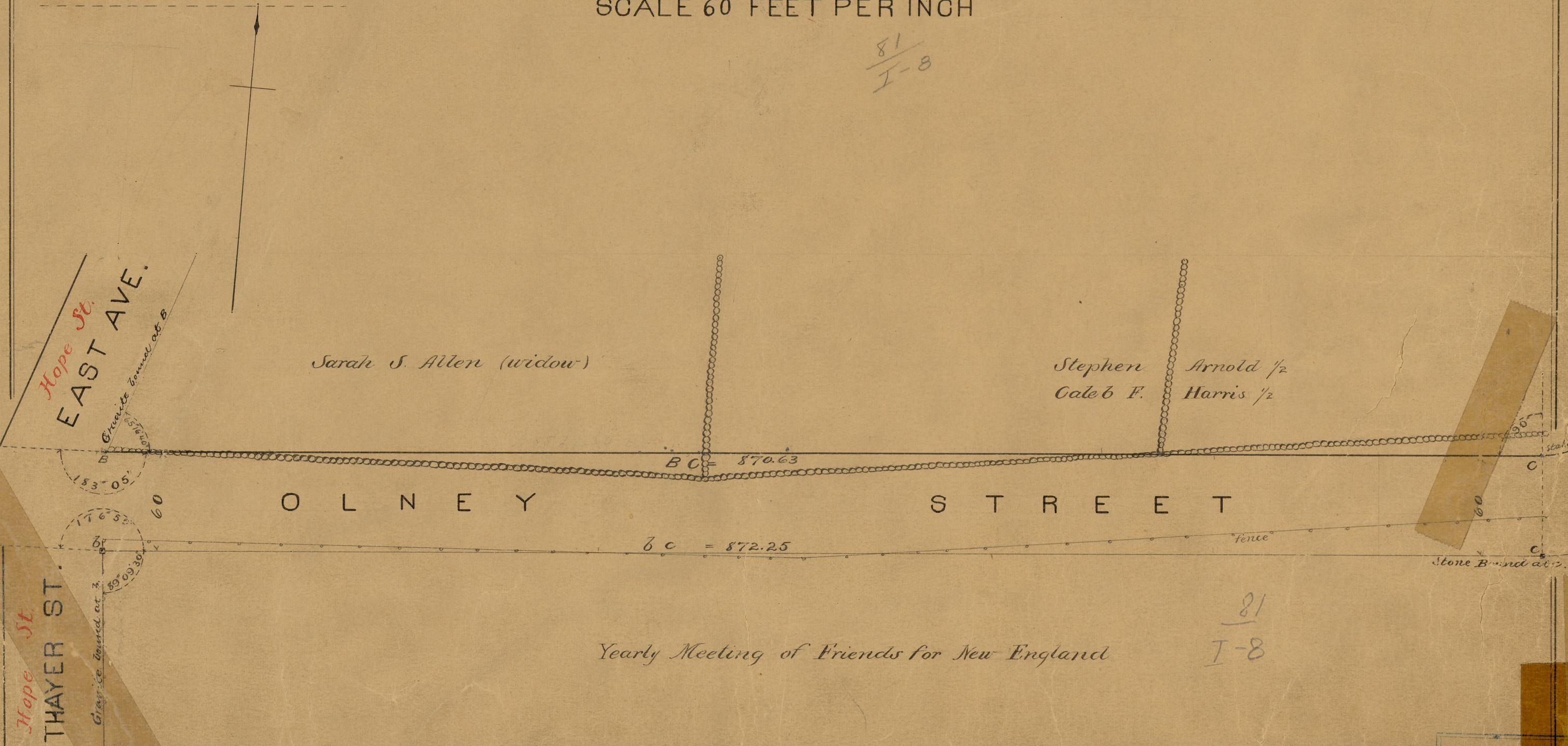

Sarah S. Allen (widow)

Stephen Arnold 1/2
Caleb F. Harris 1/2

OLNEY STREET

bc = 872.25

BC = 870.63

Yearly Meeting of Friends for New England

81
I-8

OFFICE No. 1937
DRAWN BY

81
I-8