

Scale 80 feet per inch

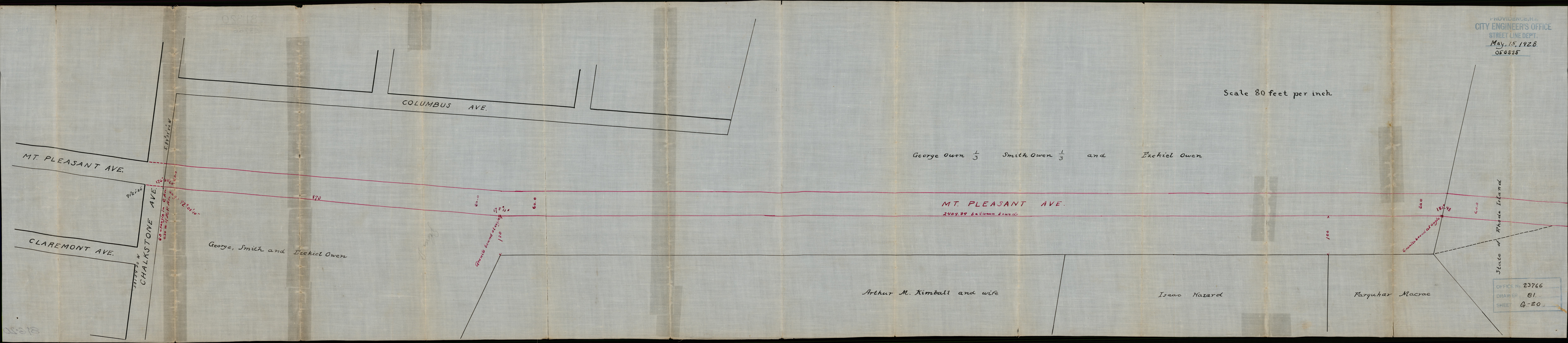

MT. PLEASANT AVE.

CLAREMONT AVE.

CHALKSTONE AVE.

COLUMBUS AVE.

MT. PLEASANT AVE.

George, Smith and Ezekiel Owen

Arthur M. Kimball and wife

Isaac Hazard

Farquhar Macrae

State of Rhode Island

OFFICE No. 23766  
DRAWER 81  
SHEET G-20