

06344

Mr. Dan^l Anthony

Scale on Hundred Feet to an Inch.

Surveyed and Platted for the Town of Providence

28th of 1798

Book 0 a Bound in the Town Plat.

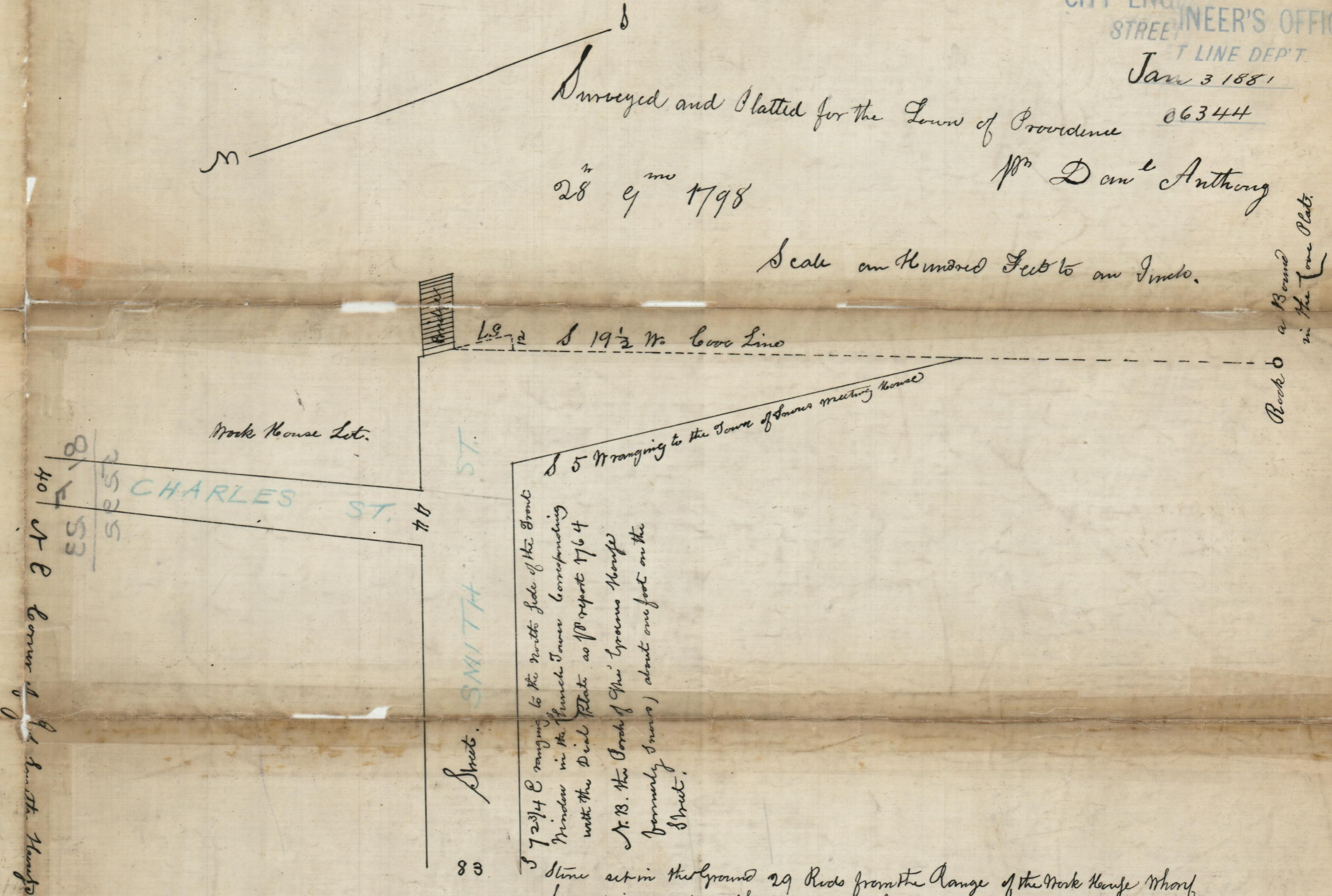

Stone set in the ground 29 Rods from the Range of the Mark House Wharf here it is supposed the Cherry Tree stood mentioned by James Angell and others in the Report of their Survey in 1764.

OFFICE No. 5292
DRAWER " 81
SHEET " F-23

Compared.

The Committee appointed on the Eighteenth Day of August last to lay out or reserve a Highway leading Westwardly from the New Bridge near the "Mark House" and for other purposes mentioned in the last annual appointment.

Respectfully Report.

I had your Committee with Mr. Daniel Stoughton as Surveyor attended by Messrs. Montagu Esq. as Justice of the Peace & Mr. William Griffin as Constable present and on the Receipt of our appointment and beginning at a stone set in the ground on the top of the Hill Westward of the Basin to in the first place of the though they are now a line S 72 3/4 E Ranging to the North side of the upper structure in the Street or West End of the corner of the Church first time; corresponding with the Survey.