

JAN 10 1881

06358

The committee, report in 1782, bounding the east line of the channel is from the South west corner of the Mill bridge to the Northwest corner of Nashes large Store, then to the North end of the foundation leg of Stills up wharf; then to the Stake near the Northwest corner of Paul Teus wharf, then to the Southwest corner of Lasparrak Allens wharf, then to the South west corner of John Smith's wharf; then to the Southwest corner of David Harris, Wharf. See the report on file

The following was ascertained in bounding out the publick waters of the cove in the year 1797 viz.  
from the northeast corner of Page's House to the Southwest corner of John Smith's wharf - West 267 feet.  
from the Street line a little North of Allens House and from thence S 73 W 238 feet ranging with the Northwest corner of Saw House to the Southwest corner of the Allens wharf.

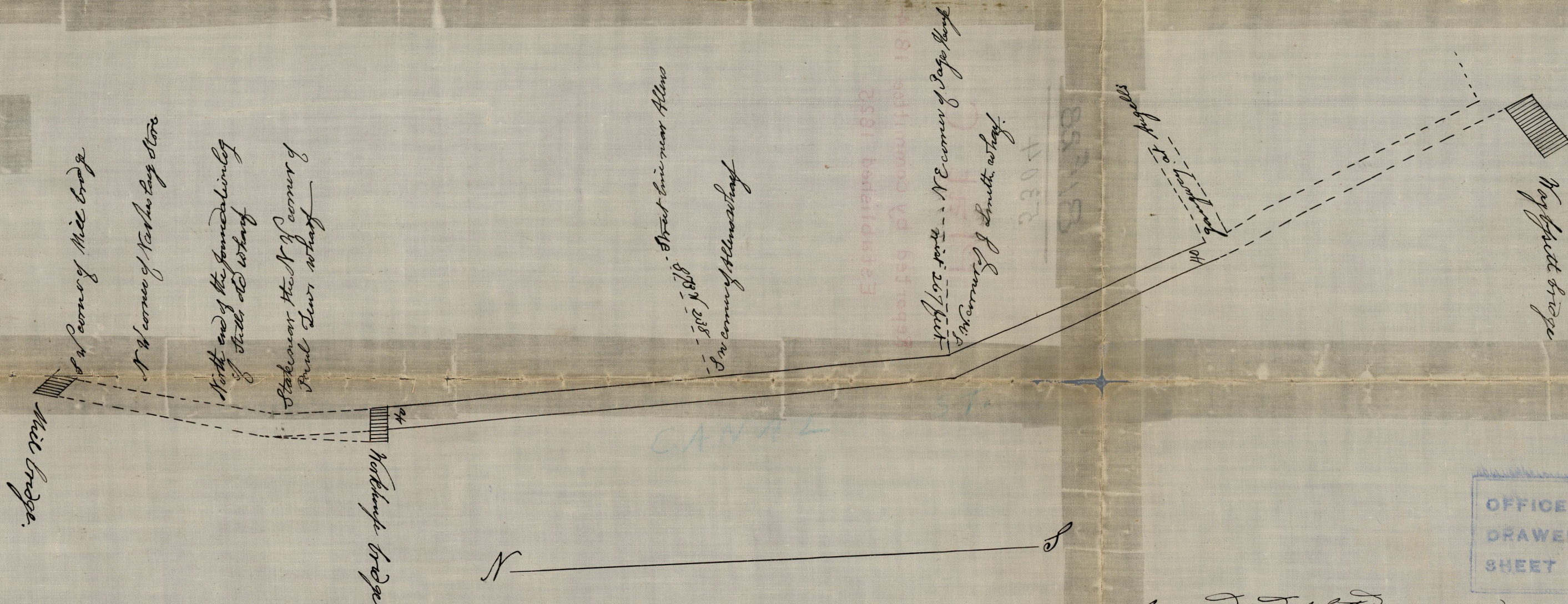

OFFICE No. 5304  
DRAWER ,, 81  
SHEET ,, F-28

Surveyed and plotted by Dan Anthony  
5 of 8<sup>th</sup> 1814  
Scale 200 feet to an Inch  
Copied from file  
Compared