

CITY ENGINEER'S OFFICE.
STREET LINE DEPT.

May 1876

03362

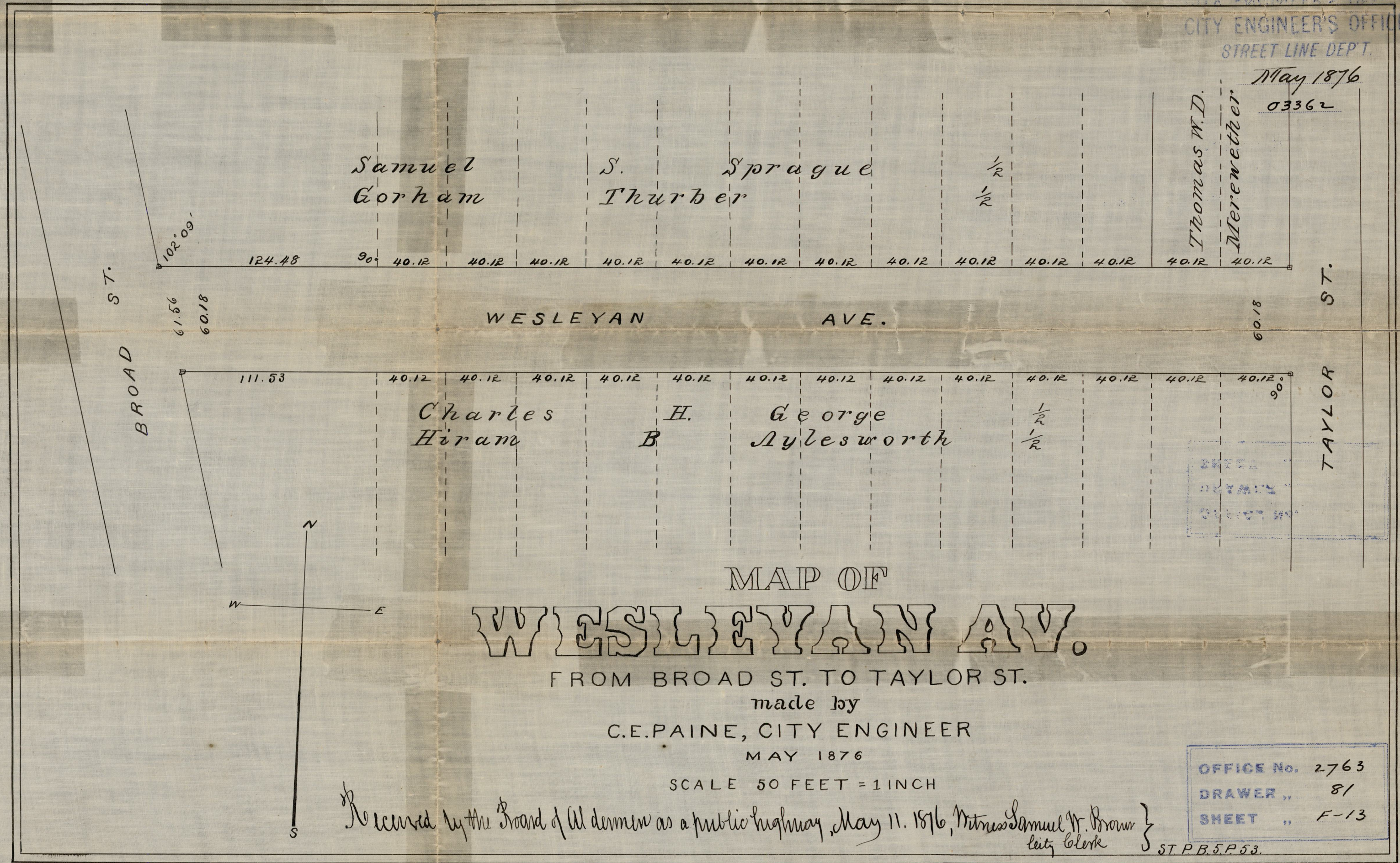

MAP OF WESLEYAN AV.

FROM BROAD ST. TO TAYLOR ST.

made by
C.E. PAINE, CITY ENGINEER
MAY 1876

SCALE 50 FEET = 1 INCH

Approved by the Board of Aldermen as a public highway, May 11, 1876, Witness Samuel W. Brown }
City Clerk

OFFICE No. 2763
DRAWER ,, 81
SHEET ,, F-13

ST. P. B. 5, P. 53.

Compared

5/23
8/13