

July 7, 1798
019

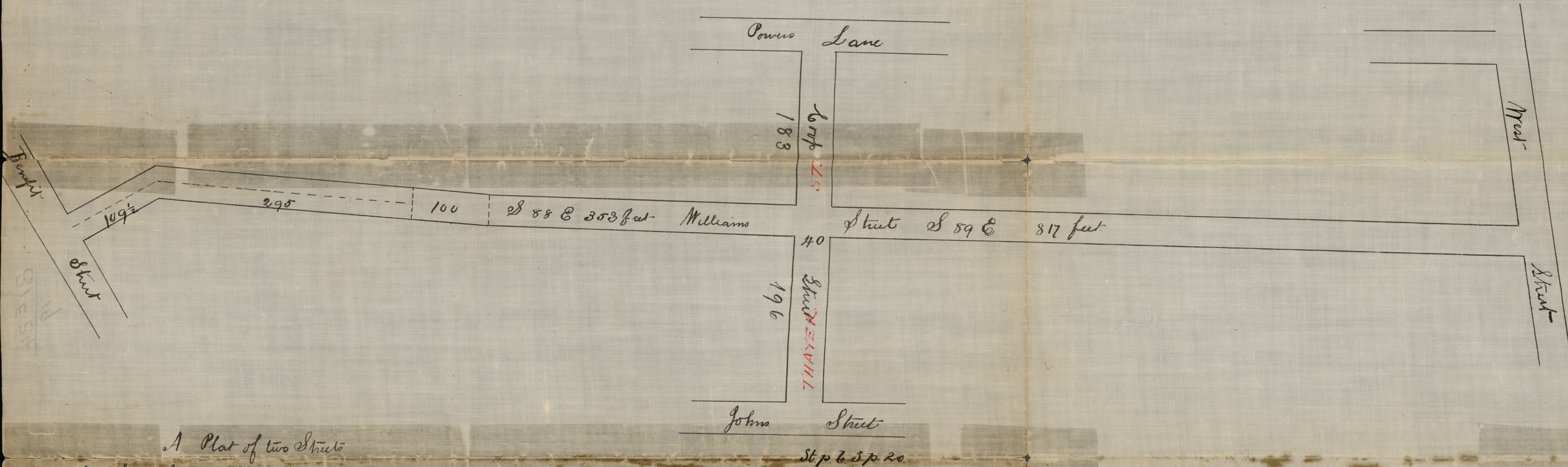

A Plat of two Streets

One of them thirty five feet wide a part of which was before laid thirty feet wide by the proprietors of the Lands adjoining thereon and recorded by the name of Williams Street and was laid out by a line in the Center as delineated by the pricked line on this Plat Viz. beginning at a point in the East line of Benefit Street, and from thence, running at right angles from said Benefit Street, one hundred nine and half feet; from thence altering its course, and running two hundred ninety and five feet further, and then terminating, which street was laid fifty feet on each side of said center line, and it is now widened 2 1/2 feet on each side, which being the corner of Nightingale's Garden, at Benefit Street, six inches on said Williams Street; And the said Williams Street is now also laid and continued the same course, to wit: 100 feet further; then S 88 E three hundred and fifty three feet, to the cross Street; then forty feet for said cross Street; then S 89 E eight hundred and seventeen feet to a street called west Street always measuring in the center or middle of said Williams Street. — The other street is a cross street forty feet wide, laid from Powers Lane to John Street, and is laid at right angles with that part of Williams Street which adjoins to and runs with ~~westward~~ ^{westward} from said cross Street

Surveyed & plotted by Danl. Anthony

7th 1798 No 1798

Scale 100 feet to an Inch

OFFICE NO.	19
DRAWER	81
SHEET	E-24

Compared.