

May 22, 1807
037

STREET LINE DEPT.
CITY ENGINEER'S OFFICE

22^d 5^{me} 1807
Scale 80 feet to an inch
Council Records 9A Page 121

Surveyed & plotted
by Danl Anthony

A Plat of Mathurson Street continued, beginning at Washington Street 7 1/2 inches from the Southeastly Corner of John Mathurson's House; and from thence in direct range to the front line of Salmon Arnold's Place and from into the Cove 39 1/2 feet to the north line of said Mathurson's Land 170 do to Sabin Street - 40 do for do 115 do to the Tide water, from thence into the Cove to the Channel

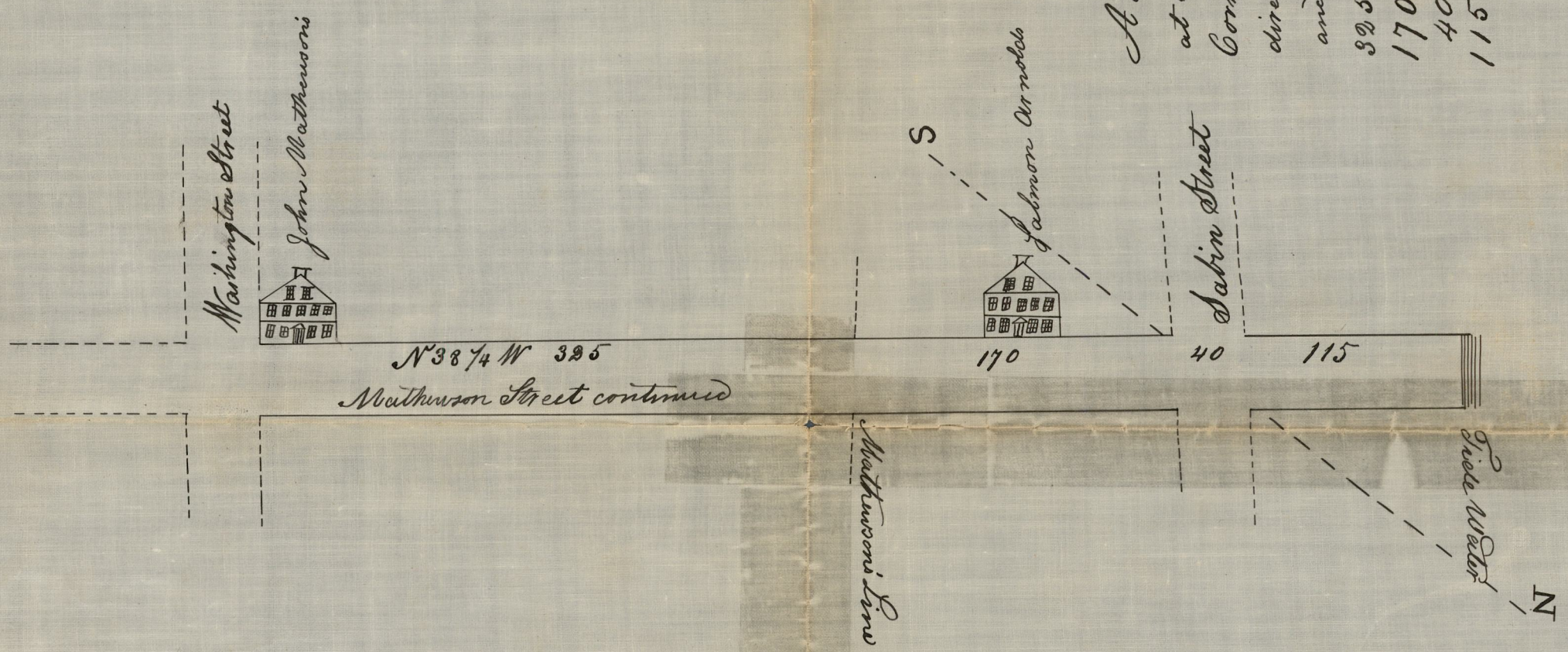

SHEET
DETAILS
OFFICE

OFFICE No. 36
DRAWER ,, 81
SHEET ,, D-13

Completed