

May 29, 1856

0433

Plat of Eddy Street in the Town of Cranston  
from the Providence and Cranston line  
to Edward Street made by order of the Town  
Council for the purpose of defining the lines  
of the Street by Cushing and Farum

May 29, 1856



Scale 100 feet to an Inch  
Old Providence Measure  
The bounds marked thus [\*] were set by  
the surveyor on the present occasion. The other  
land marks were noted as found upon the ground

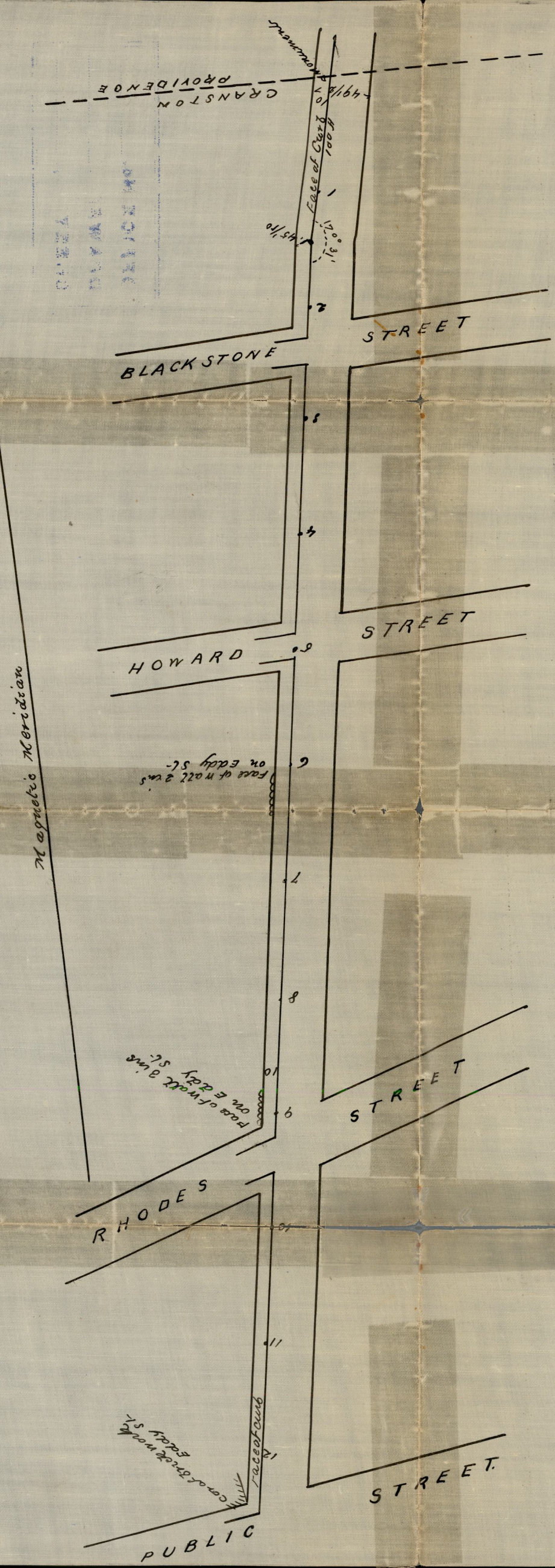

Copied from C.R. 6-254

OFFICE No. 422  
DRAWER " 81  
SHEET " C-32

COMPARED.

Joseph S. Fitts  
Asst Engineer.