

Nov. 16, 1876
03520

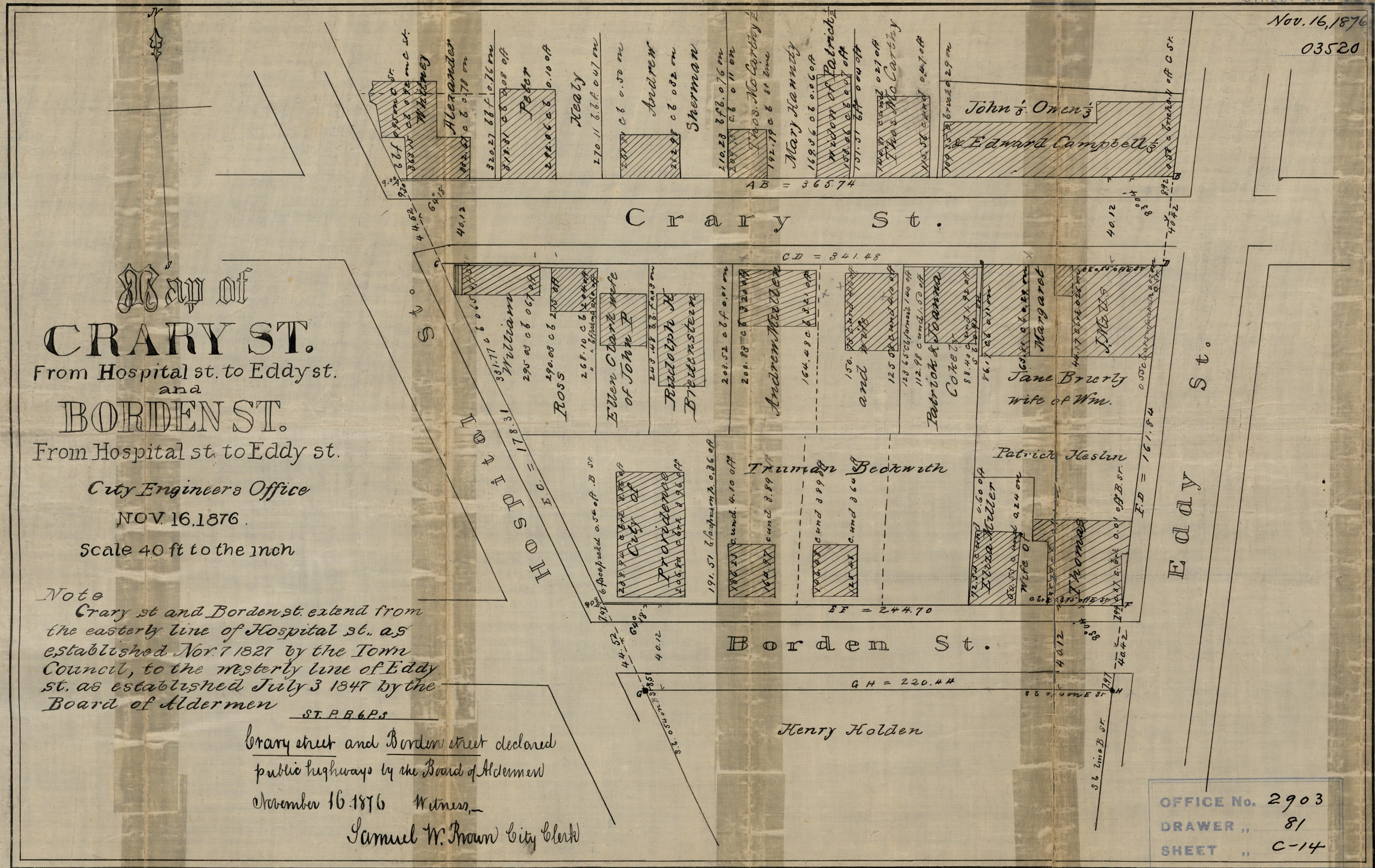

Map of
CRARY ST.
From Hospital st. to Eddy st.
and
BORDEN ST.
From Hospital st. to Eddy st.

City Engineer's Office
NOV. 16. 1876.
Scale 40 ft to the inch

Note
Crary st and Borden st. extend from
the easterly line of Hospital st., as
established Nov. 7 1827 by the Town
Council, to the westerly line of Eddy
st. as established July 3 1847 by the
Board of Aldermen

ST. P. B. & P.
Crary street and Borden street declared
public highways by the Board of Aldermen
November 16. 1876 Witness,
Samuel W. Brown City Clerk

OFFICE No. 2903
DRAWER ,, 81
SHEET ,, C-14

Compared