

CITY ENGINEER'S OFFICE
STREET LINE DEPT.

152-152
CITY ENGINEER'S OFFICE
STREET LINE DEPT.

Aug. 6, 1860
0536

PLAT of HOWELL ST.

from the East Turnpike to Camp St as delineated
on a Plat of House Lots belonging to E. P. Knowles & others

Recorded in Book of Plats No. 3 page 48 & dated May 10th 1847

Providence Aug 6th 1860

By N. B. Schubarth

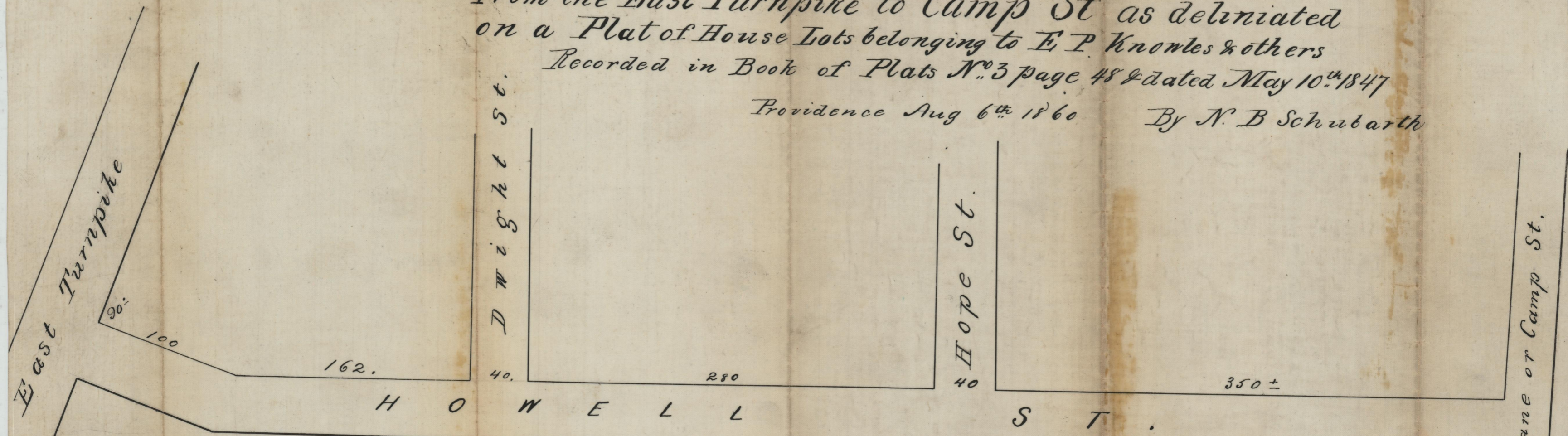

Scale 60 F^t to inch
Measure Old Prov. St^d
Street Plat Book 4 Page 31

Recorded by order of the Board of Aldermen August 13, 1860. See Record of Streets No 2 page 285.
Witness, Samuel W. Brown City Clerk

OFFICE No.	521
DRAWER	81
SHEET	B-29

Compared

CITY ENGINEER'S OFFICE
DRAWN BY
SHEET