

Copy of 02998

Feb. 8, 1917
042482

WILLIAMS ST.

PE A 18
P 245

MAP
OF
WILLIAMS STREET

FROM GOVERNOR ST.
TO IVES ST.

Made by order of the
Hon Board of Aldermen.

City Engineers Office

Declared a Highway

October 28, 1875

Oct 28, 1875.

Witness J. M. Brown City Clerk

St. Book of Plats 5 page 44

Scale 50 ft per inch

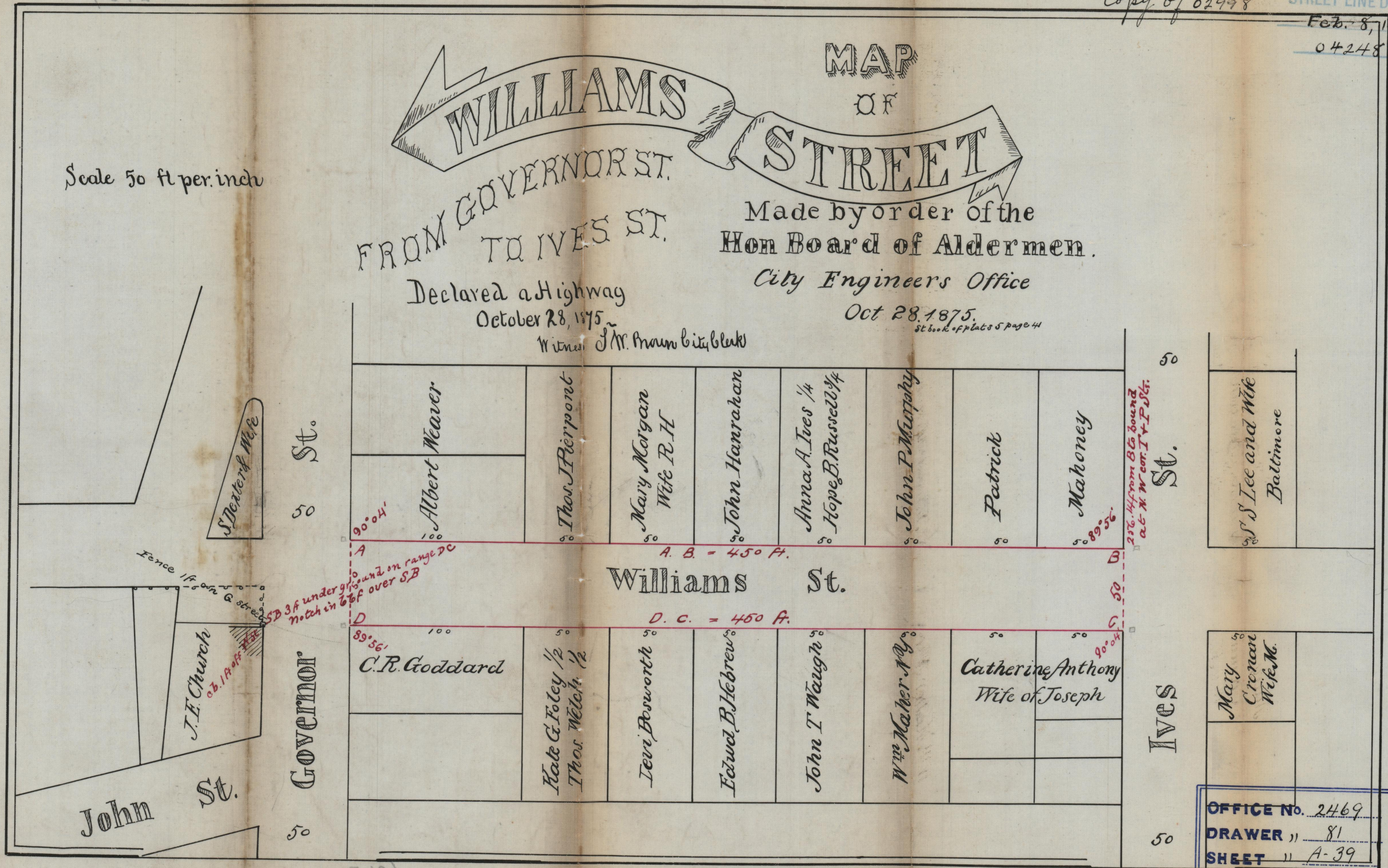

S. Dexter & Wife

Fence 1/2 on G street

J. E. Church
ob. 1/4 off 1/2

John St.

St.

50

GOVERNOR

50

90° 04'

A. B. = 450 Ft.
D. C. = 450 Ft.

89° 56'

89° 56'

256.44 from B to bound
at N. W. cor. I + I Sts.

50

St.

50

IVES

50

S. S. Lee and Wife
Baltimore

Mary Cronan
Wife M.

OFFICE NO. 2469
DRAWER " 81
SHEET " A-39

Compared