

M A P
of
Prairie Avenue
made for the Proprietors in compliance with
a Resolⁿ of the Board of Aldermen passed Aug 8th 1859.
surveyed and drawn
By *Wm Hamis*
January 1860

Scale 60 feet to an inch
Measured by U.S. Standard
Sheet Plat Book 4 Page 30

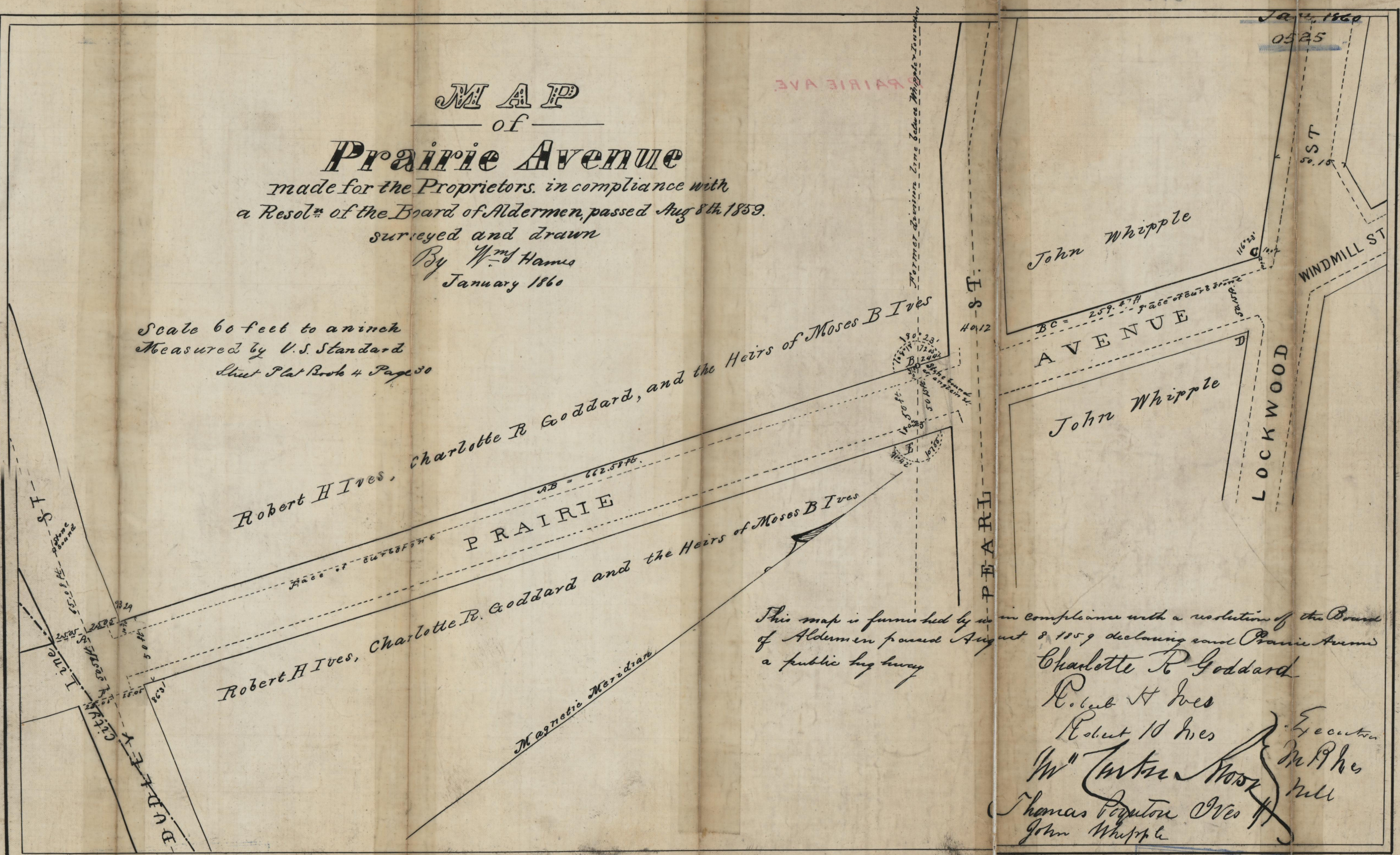

This map is furnished by *Wm Hamis* in compliance with a resolution of the Board of Aldermen passed August 8 1859 declaring said Prairie Avenue a public highway

Charlotte R Goddard
Robert H Ives
Robert H Ives
Wm Carter
Thomas Popaton
John Whipple

John Whipple
John Whipple

OFFICE No. 510
DRAWER " 81
SHEET " A-37

Compared