

Map of  
Dover St. Fire Station Lot.

Scale 40 ft. per inch.

PROVIDENCE, R. I.  
CITY ENGINEERS OFFICE.  
CITY PROPERTY DEPT.  
June 18, 1902.

031013.

1356

City of Providence bought of Walter Callender Sept. 30, 1902 for \$1200  
Lot ABCD containing 7500 square feet. See deed book 442 page 391.

Stone bounds were placed as hereon shown Nov. 11, 1902.

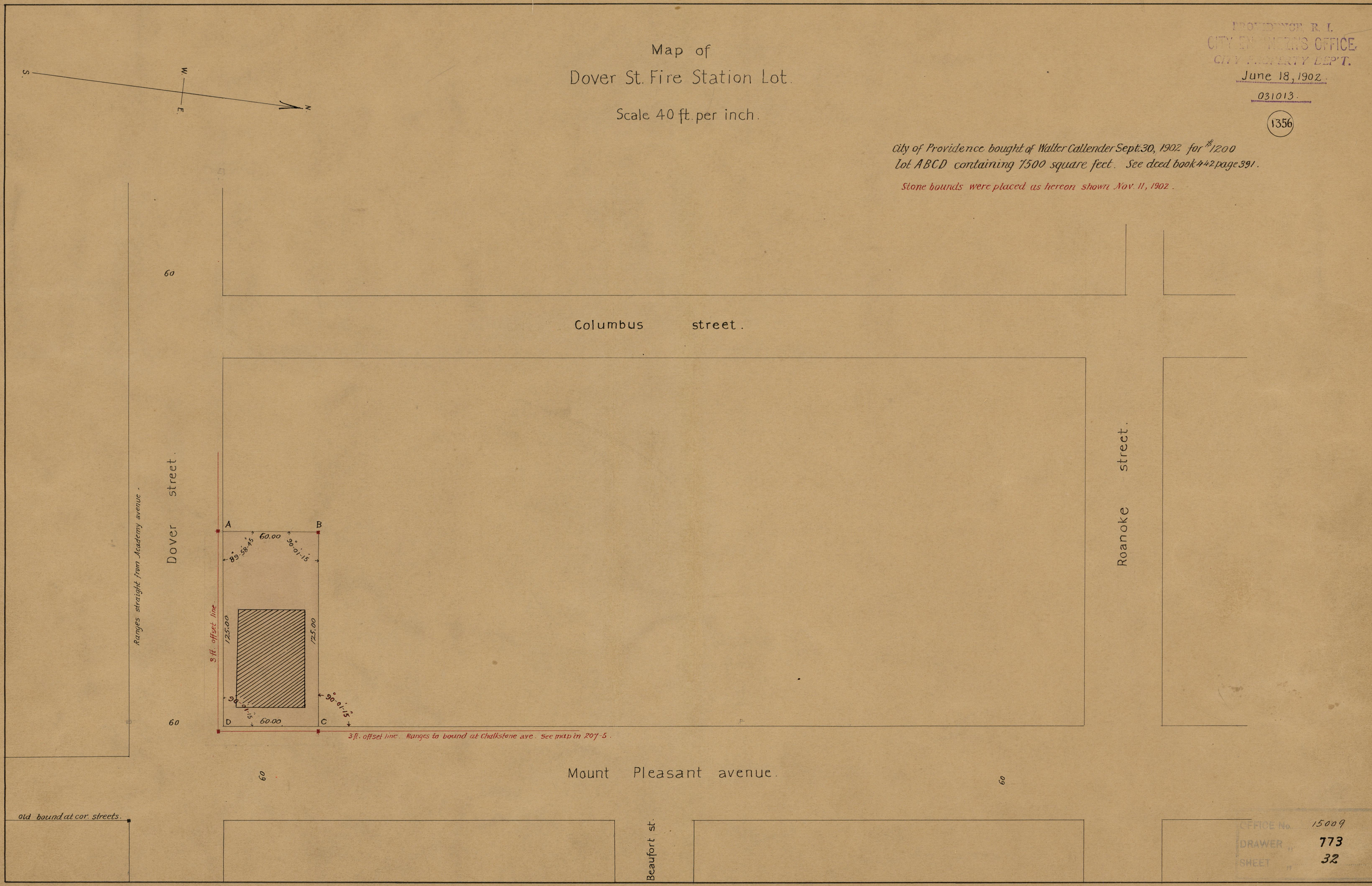

OFFICE No. 15009  
DRAWER 773  
SHEET 32