

May 16, 1900.

029343

City of Providence bought of Presbary Hoxie May 10, 1900
for \$2400 lot ABCD. See deed book 432 page 102
Stone bounds were placed around this lot October 8, 1900.

Map of
Webster ave. School Est.

Scale, 40 ft. per inch.

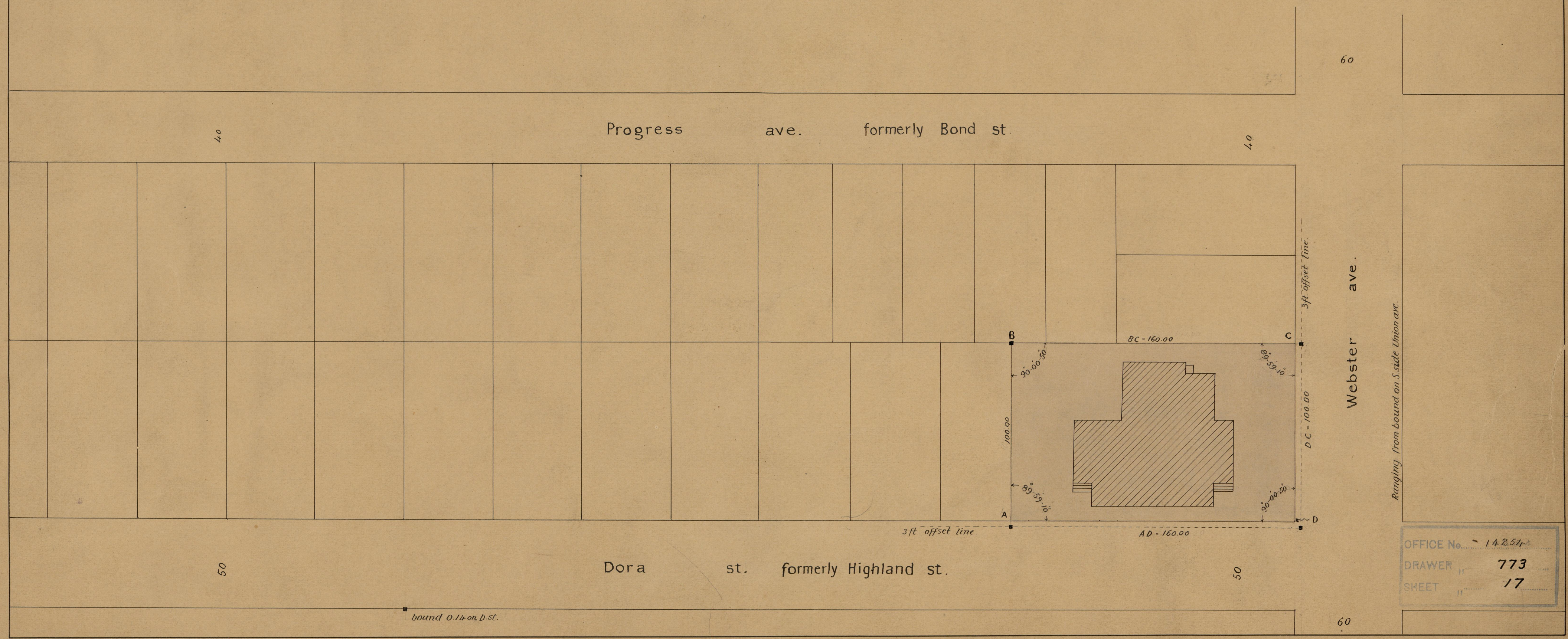
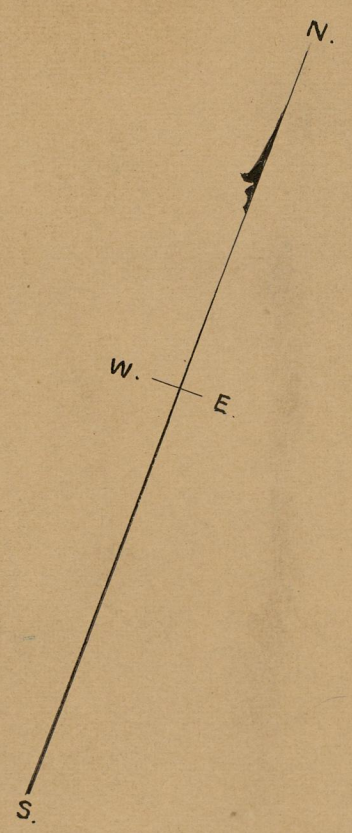

Ranging from bound on S. side Union ave.

OFFICE No. 14254
DRAWER 773
SHEET 17