

MAP OF Congress Ave. School Est.

Scale 40 ft. per inch.

Stone bounds were placed at each corner of this estate July 13, 1892.
The building was added to this map Feb. 2, 1904.

PROVIDENCE, R. I.
CITY ENGINEER'S OFFICE.
CITY PROPERTY DEPT.
JUNE 2, 1891.
017861.

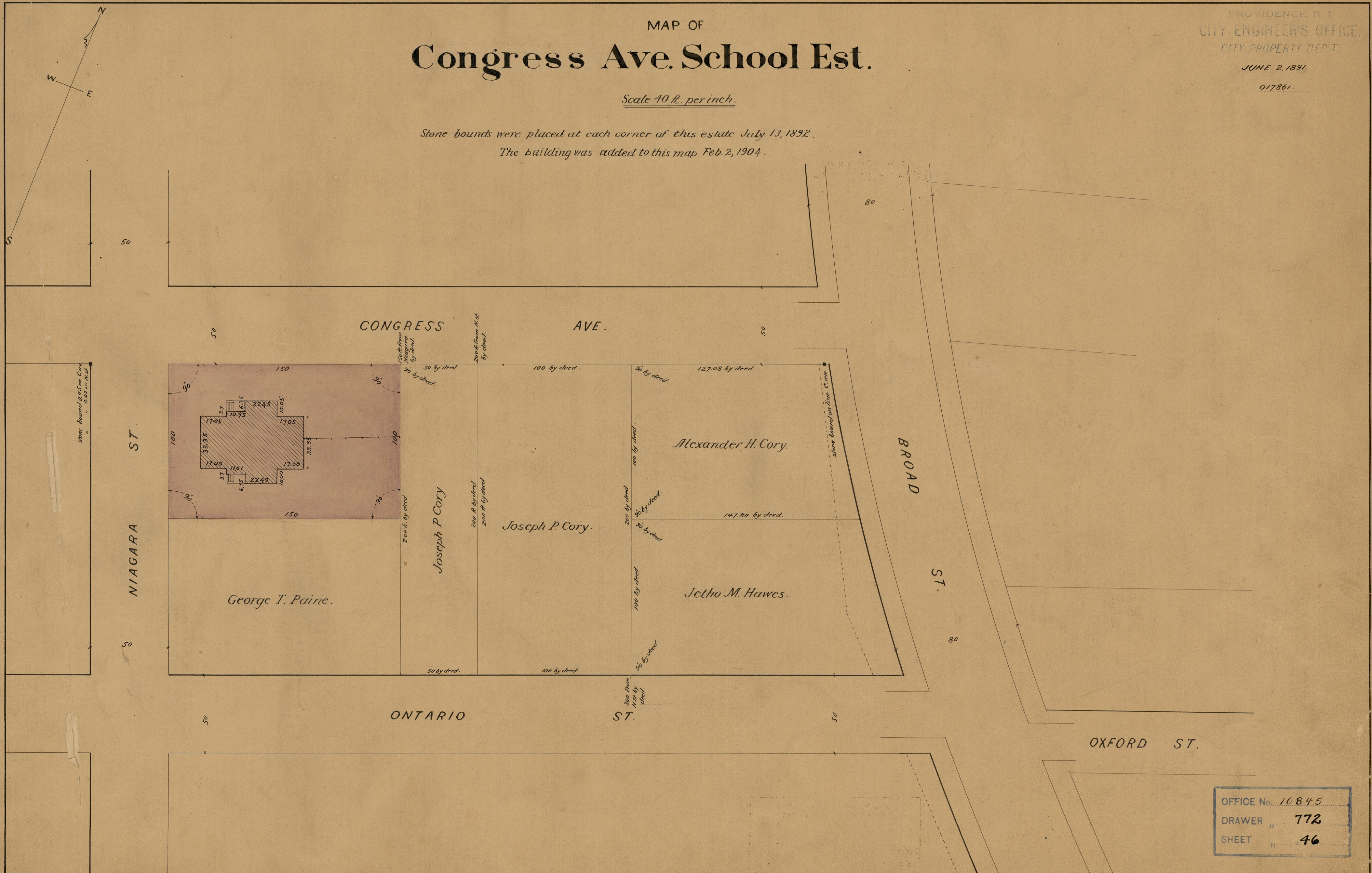

OFFICE No. 10,845
DRAWER " 772
SHEET " 46