

Area = 13635 sq ft Oct 6/1889

PROVIDENCE, R. I.
CITY ENGINEER'S OFFICE.
CITY PROPERTY DEP'T.

MAP OF AMHERST STREET SCHOOL ESTATE

City of Providence bought of Susan and Patrick McHenna
lot ABCD comprising lots 93, 94, 95, 96 on a plat of
building lots belonging to E. N. Steere drawn by
W^m S. Haines June 1864 on Card 348, Recorder's Office
Deed dated Jan. 13, 1880, and recorded in Book 302 p. 377

Sept. 13, 1889
015475

Scale 20 ft. per inch

Stone bounds were placed at points ABCD Sept 27-1880

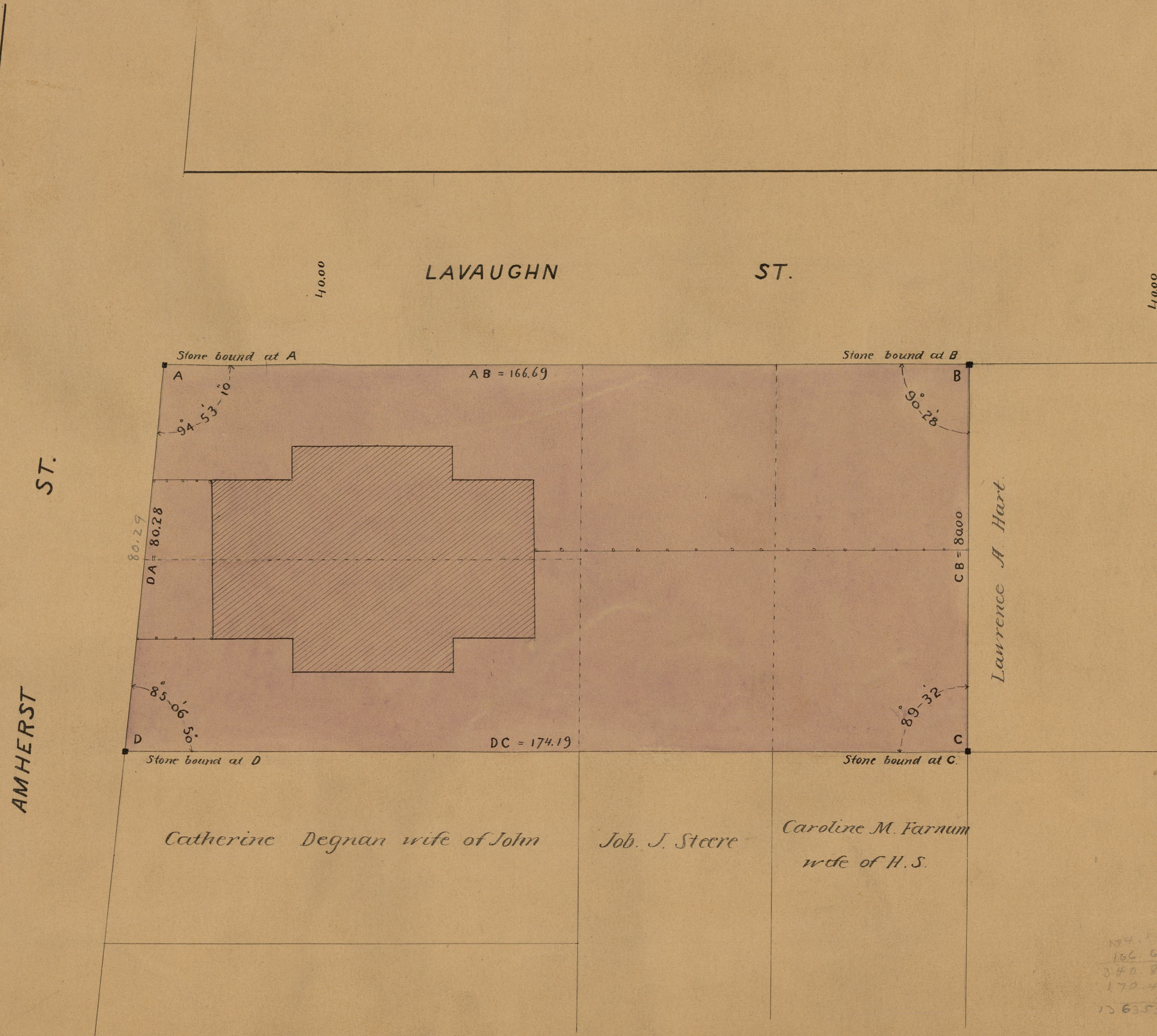
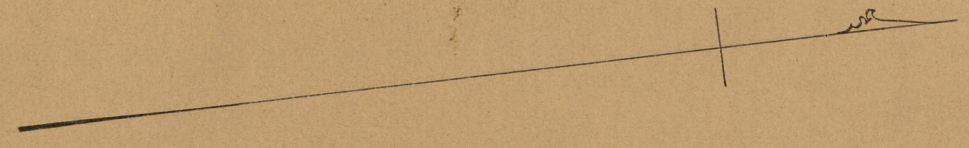

174.19
166.69
340.88
170.40
80
13635.20

OFFICE No.	10248
DRAWER	772
SHEET	33