

# MAP OF HIGHLAND AVENUE, SCHOOL ESTATE.

Scale 20 ft. per inch.  
 Area of ABCD = 15,000 Sq. ft.  
 Stone Bounds set at A.B.C.D. Nov. 20, 1890.  
 Red figures added Oct. 31, 1896.

HIGHLAND AVENUE.

Ranging from stone bound at 5<sup>th</sup> St. to stone bound at 9<sup>th</sup> St. assumed line

Catherine J. Hunt  
 Rehoboth, Mass.

Catherine J. Hunt  
 Rehoboth, Mass.

Catherine J. Hunt  
 Rehoboth, Mass.

Catherine J. Hunt Rehoboth, Mass.

Charles F. Wright

James T. Wightman  
 and wife Patience

SIXTH STREET.

SEVENTH STREET.

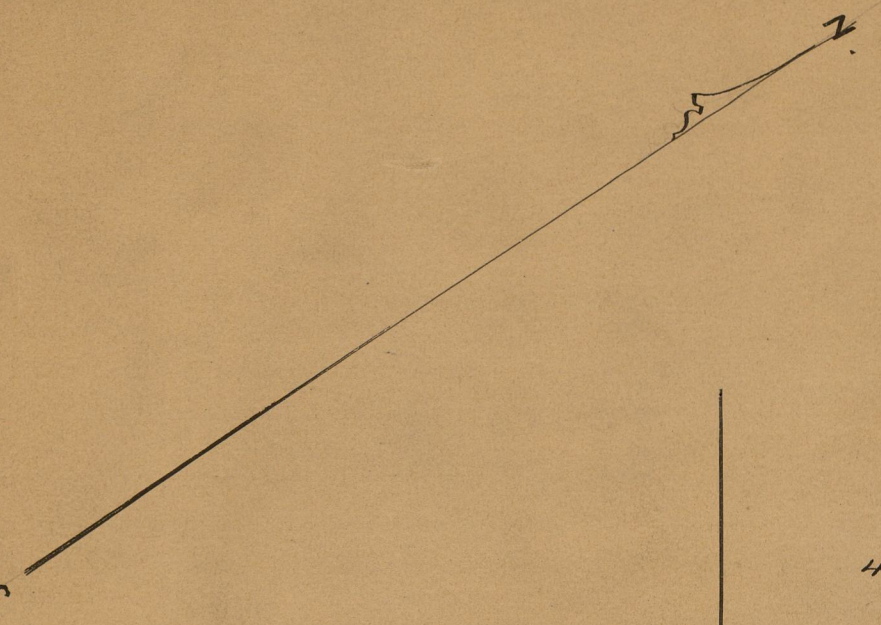
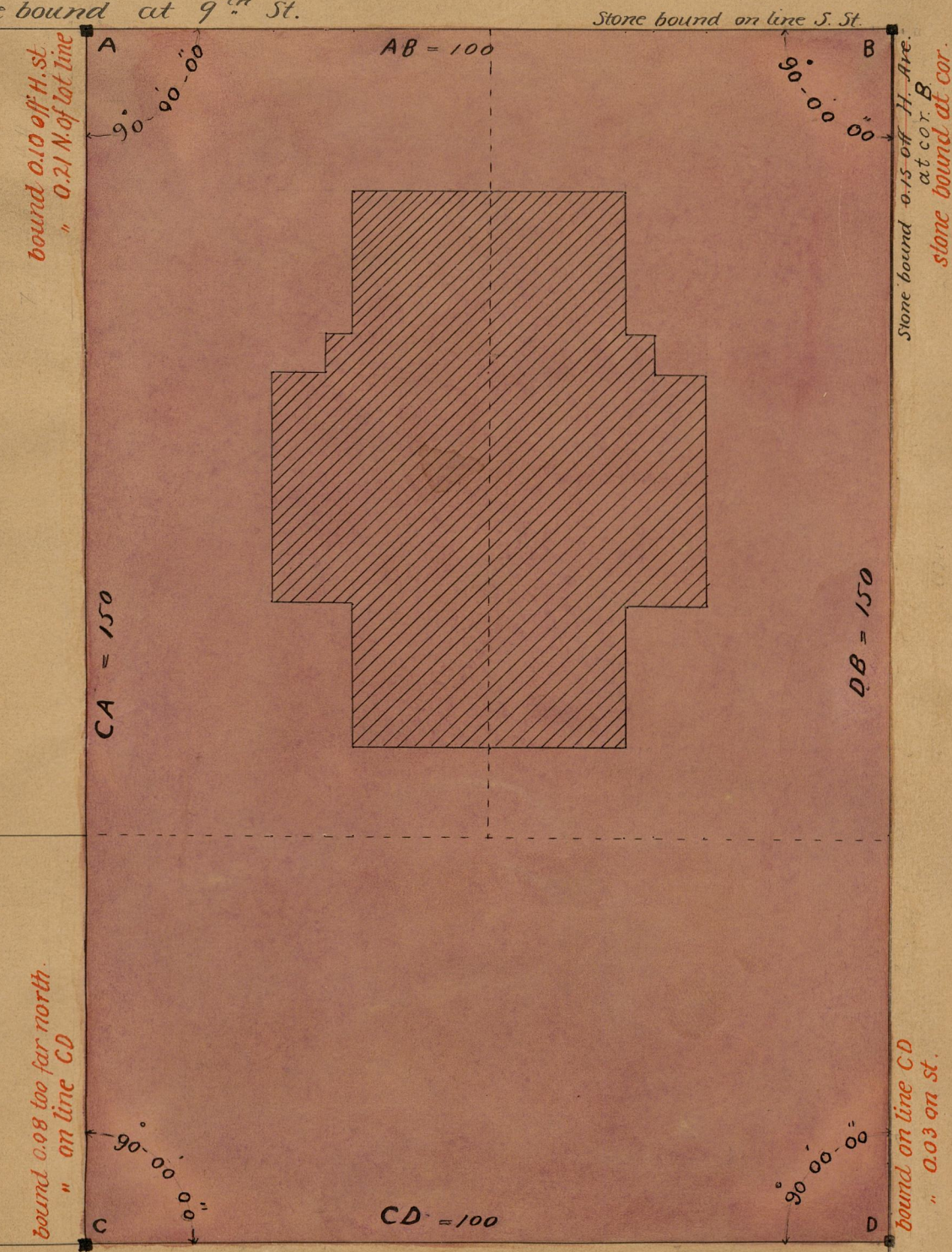

91  
 223

OFFICE No. 10122  
 DRAWER 772  
 SHEET 32