

OCT. 28 1885.

Q11 369.

MAP OF  
*Bellevue Ave. Lots.*

Scale 20 ft. per inch.

Stone bounds were placed at ABCD NOV. 4, 1885.  
Stone bounds B & C were lowered Nov. 10, 1886.

The building was put on this plat Feb. 2, 1904.

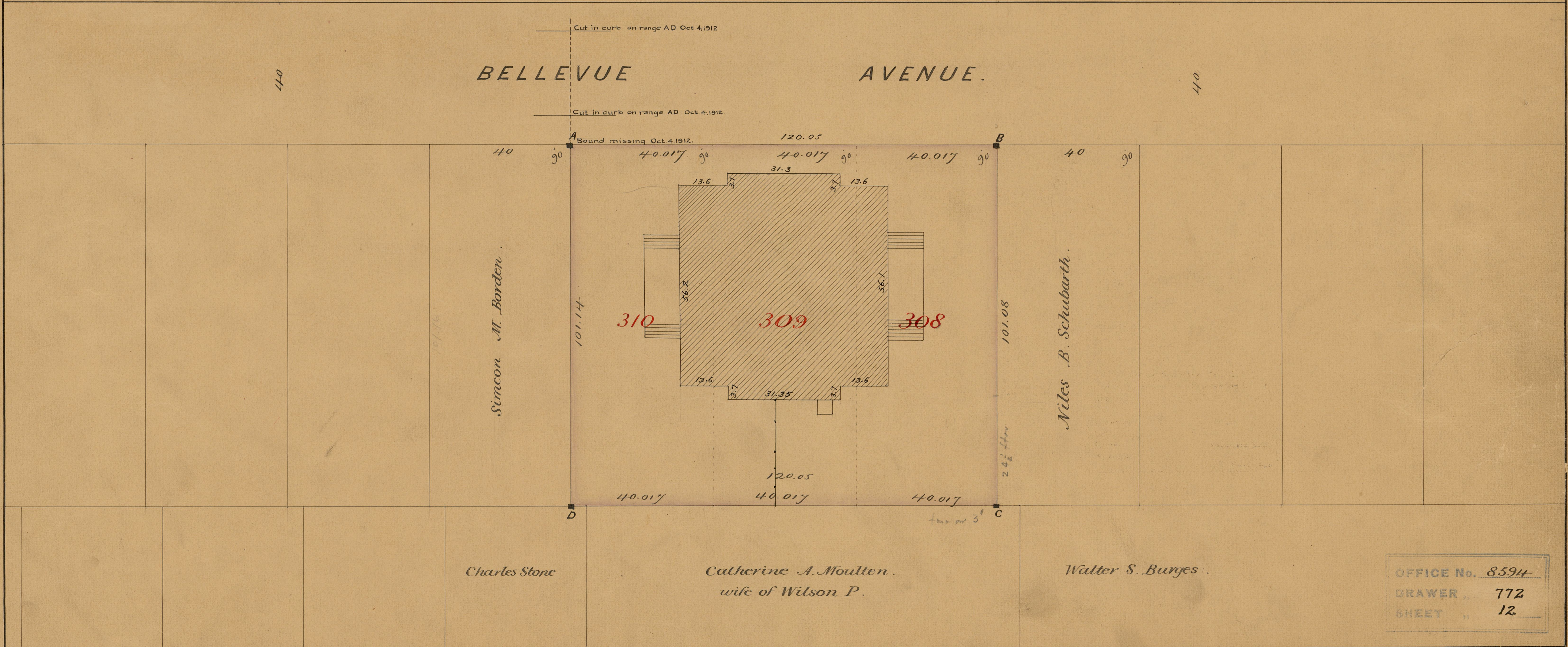
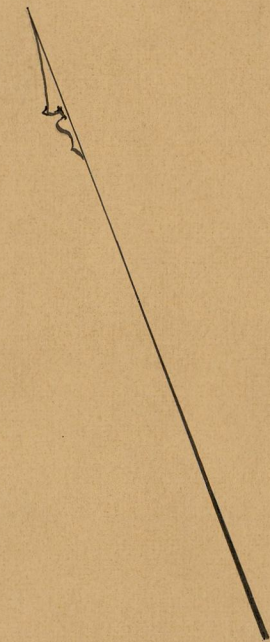

OFFICE No. 8594  
DRAWER 772  
SHEET 12