

Map of Messer St. School Est.

Scale 40 ft per inch.

PROVIDENCE, R. I.
CITY ENGINEER'S OFFICE.
CITY PROPERTY DEPT.

JUNE 5, 1884.

09997

Rufus Waterman trustee to the Estate of Sally Thompson sold to City of Providence Oct 15, 1868 lots 54 & 55 on Plat of lots formerly owned by the heirs of Nathan and Rufus Waterman See Deed Book 184 page 116.

Stone Bounds were placed at corners ABC & D June 1884.

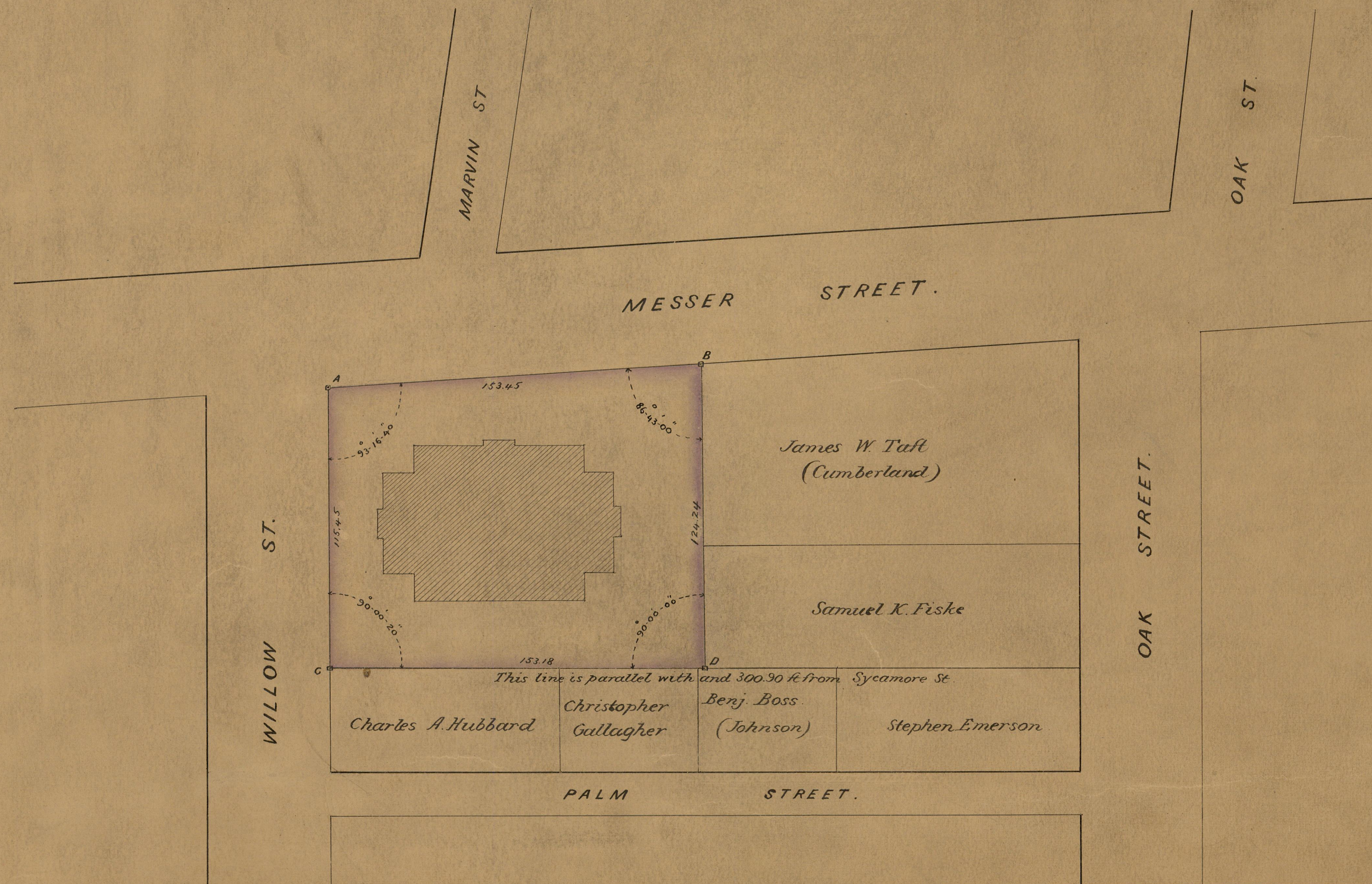
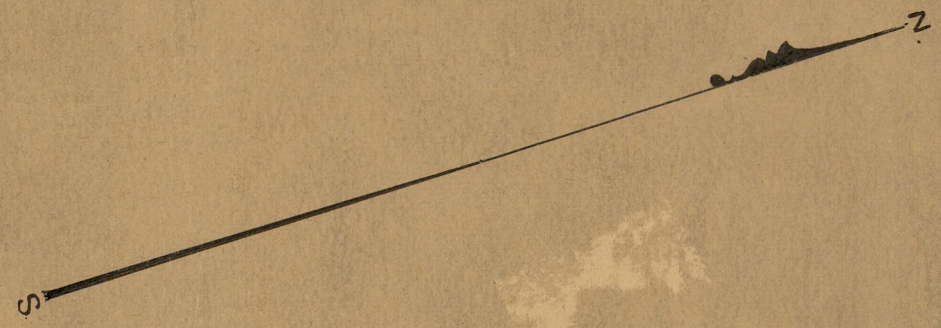

OFFICE No. 8027
DRAWER ,, 771
SHEET ,, 50