

MAP OF  
Eddy st. School Est.  
Scale, 30 feet per inch.

PROVIDENCE, R. I.  
CITY ENGINEER'S OFFICE,  
CITY PROPERTY DEPT.

May 6, 1878.

04310

Building added and other changes made Feb. 3, 1904.

Red notes added May 23, 1911.

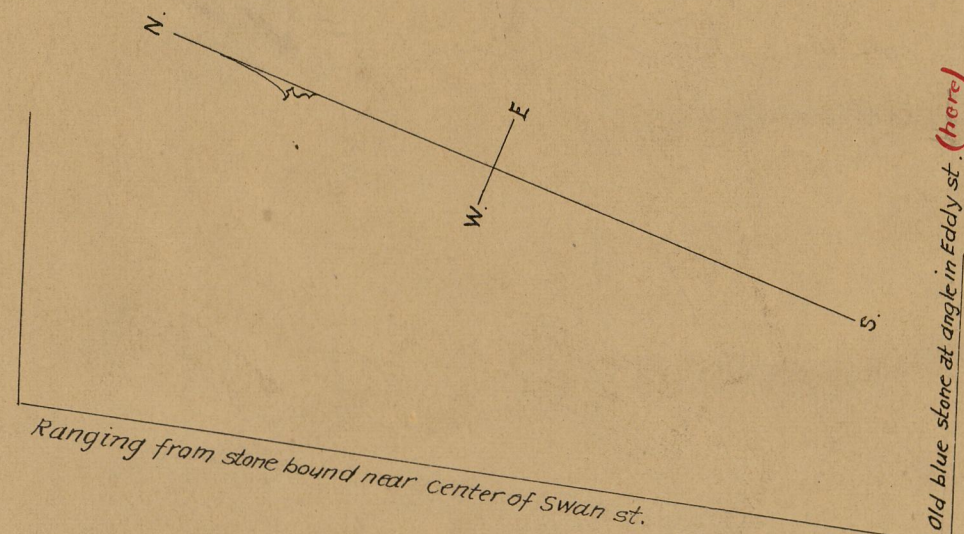

Ranging from stone bound near center of Swan st.

Mutual st.

Oxford st.

Fourth School District of Town of Cranston bought of Sylvester R. Jackson June 17, 1865 lot ABCDE. See deed book 230 page 517, being lot 763 on Assessor's plat 47 containing 12524 square feet.

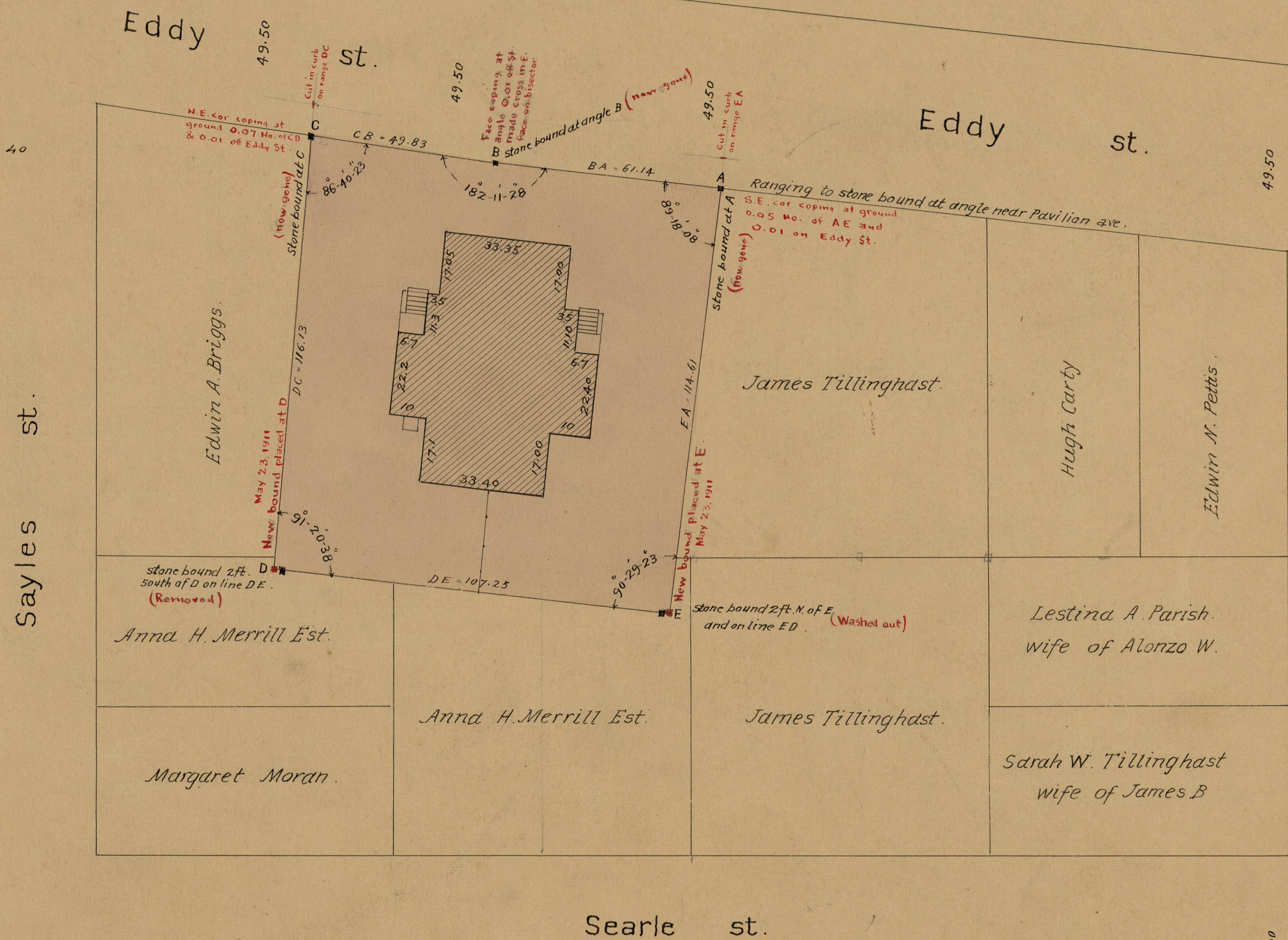

Sayles st.

Oxford st.

Searle st.

OFFICE No. 3555  
DRAWER 771  
SHEET 43