

293 1681 09 ft
 294 3925 " "
 264 4491 " "

70 c = 2747.00
 70 c = 3143 3191.30

589.00 5807.00

Map of Work House Lot.

Scale, 30 ft. per inch.

Red figures added July 1, 1896
 Blue figures added June 25, 1897
 Green figures added Dec. 3, 1917

This is a portion of the land remaining to the town of Providence after a grant to John Smith (miller) in 1646 of "land in the valley where his house stands for erecting a grist-mill etc"

PROVIDENCE R. I.
 CITY ENGINEER'S OFFICE.
 CITY PROPERTY DEPT.
 Sept. 14 1894.
 023062



smith street.

Areas	
CDEFBC	1700 Sq. Ft.
HIDCGH	3851 " "
JKIHJ	4559 " "
MNOPQRLM	3187 " "

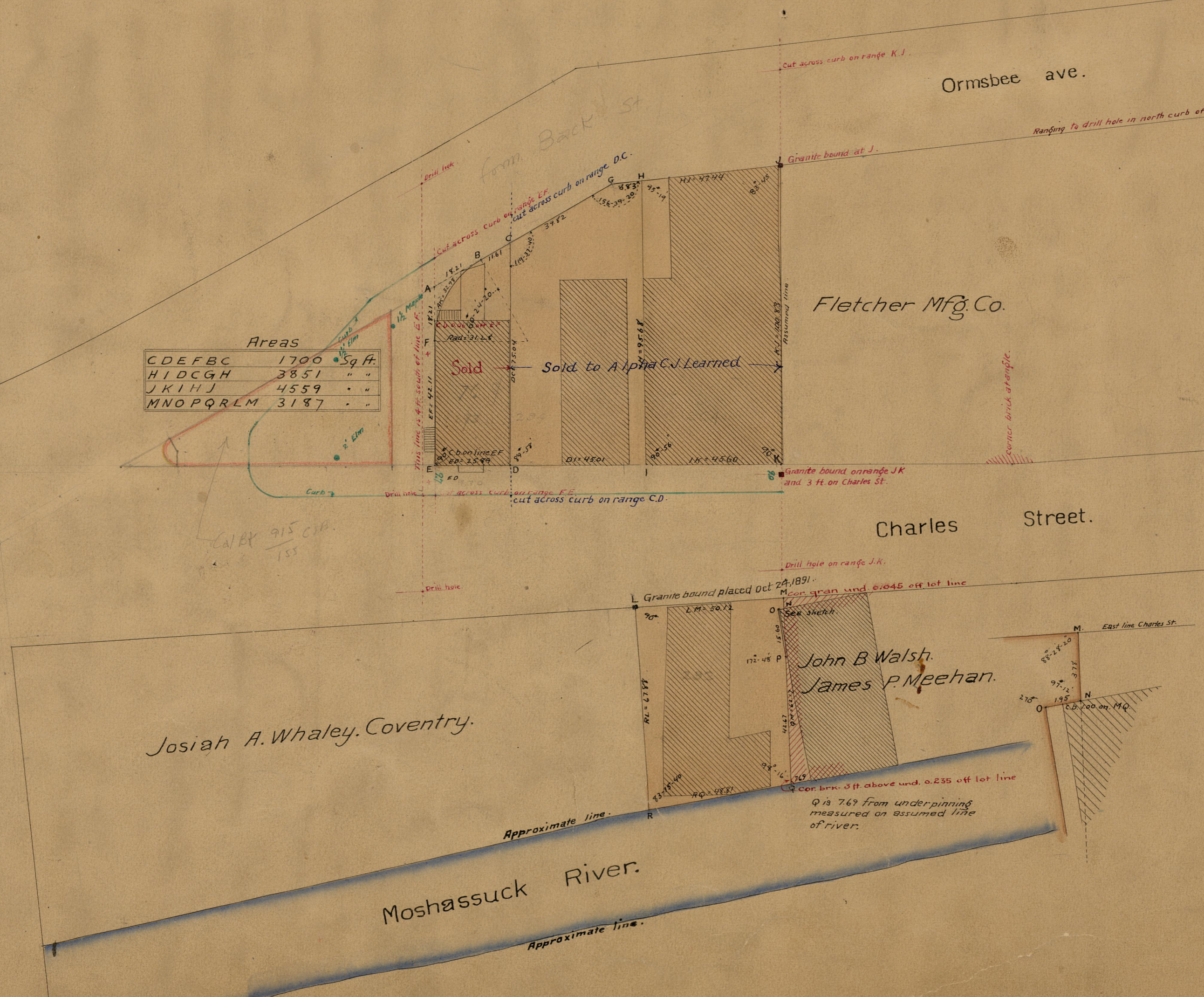

City of Providence sold to Augustine Giblin May 25 1896 the lot C, D, E, F, B, C recorded in book 400 page 274
 City of Providence sold to Alpha C. J. Learned the tract C, G, H, J, K, I, D, C deed recorded in book 407-128 126

OFFICE No. 12627
 DRAWER 771
 SHEET 32