

SEPT. 15, 1948

059956

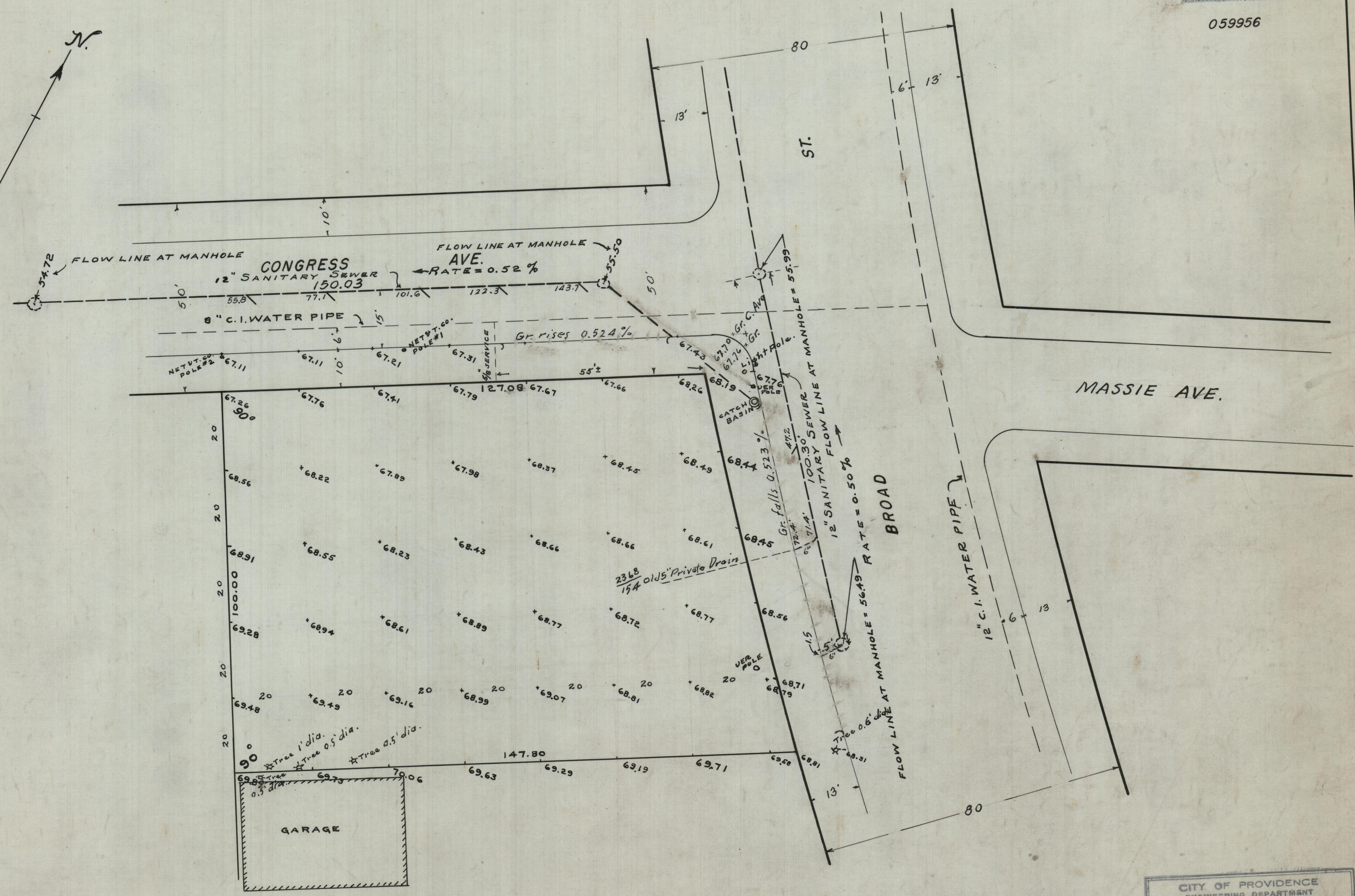
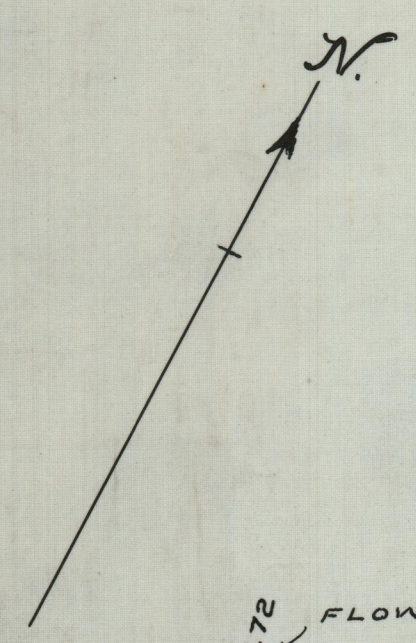

BASE = MEAN HIGH WATER.

Sewer Branches - 6" dia.

CITY OF PROVIDENCE
ENGINEERING DEPARTMENT
Showing BROAD ST. & CONGRESS AVE.
FIRE STATION SITE TOPOGRAPHY.
Drawn By G.W.S. Checked By W.L.B.
Scale 1" = 20' Date SEPT 15, 1948
Corrected by William J. Bagley Asst. Eng.
Approved by John E. Meade City Eng.