

SEPT. 15, 1948  
059955

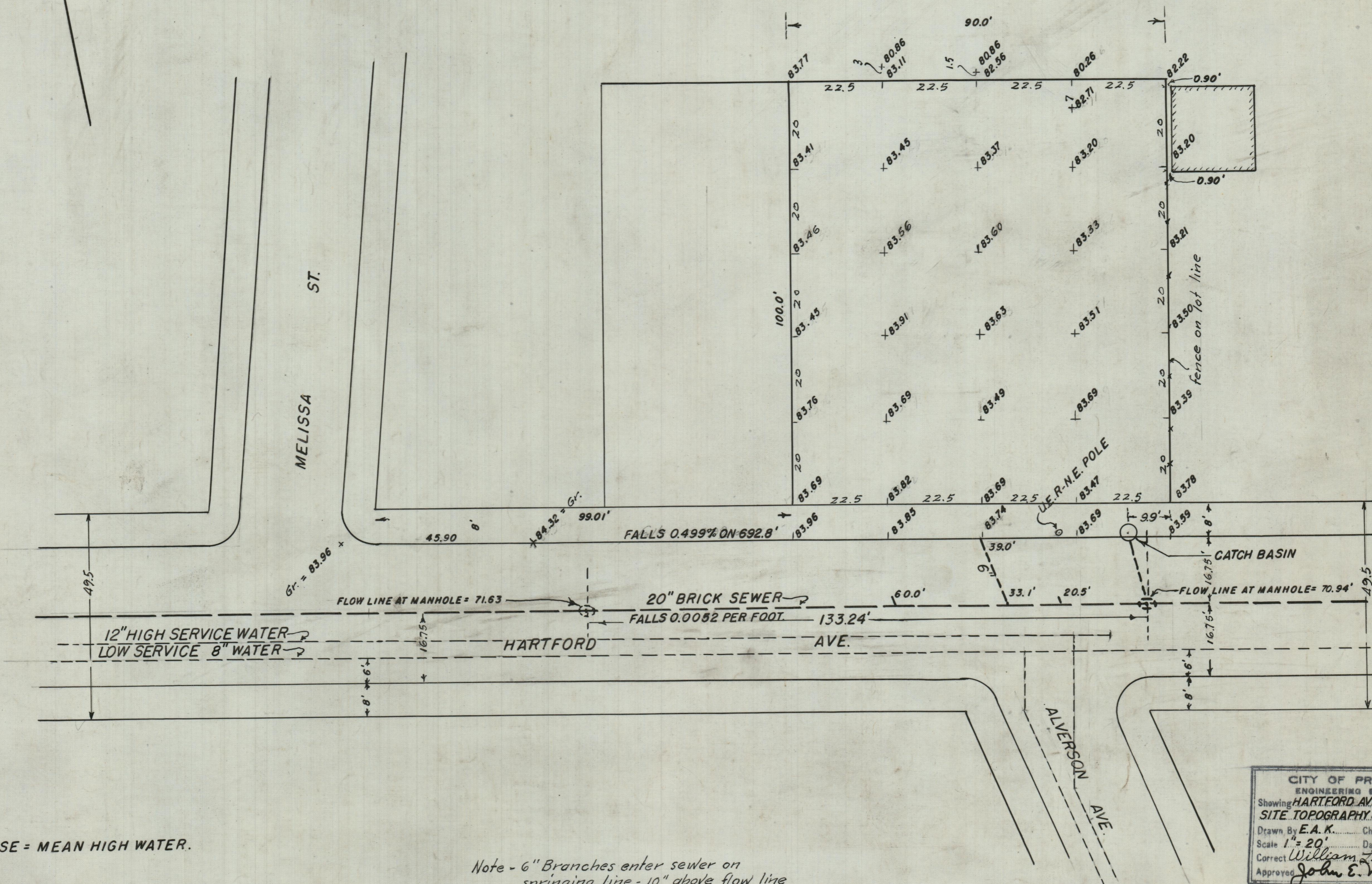
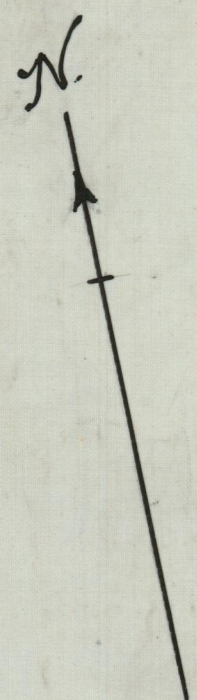

BASE = MEAN HIGH WATER.

Note - 6" Branches enter sewer on springing line - 10" above flow line

CITY OF PROVIDENCE  
ENGINEERING DEPARTMENT  
Showing HARTFORD AVE. FIRE STATION  
SITE TOPOGRAPHY & UTILITIES  
Drawn By E.A.K. Checked by W.L.B.  
Scale 1" = 20' Date SEPT. 15, 1948  
Corrected by William L. Bagley, Asst. Eng.  
Approved John E. Meade, City Eng.