

Res. No. 354
Exp. 7/11/66

PROVIDENCE, R. I.
P. W. DEPT. - ENGINEERING OFFICE
CITY PROPERTY SECTION
Plan No. 062986
Date: JUNE 1, 1966

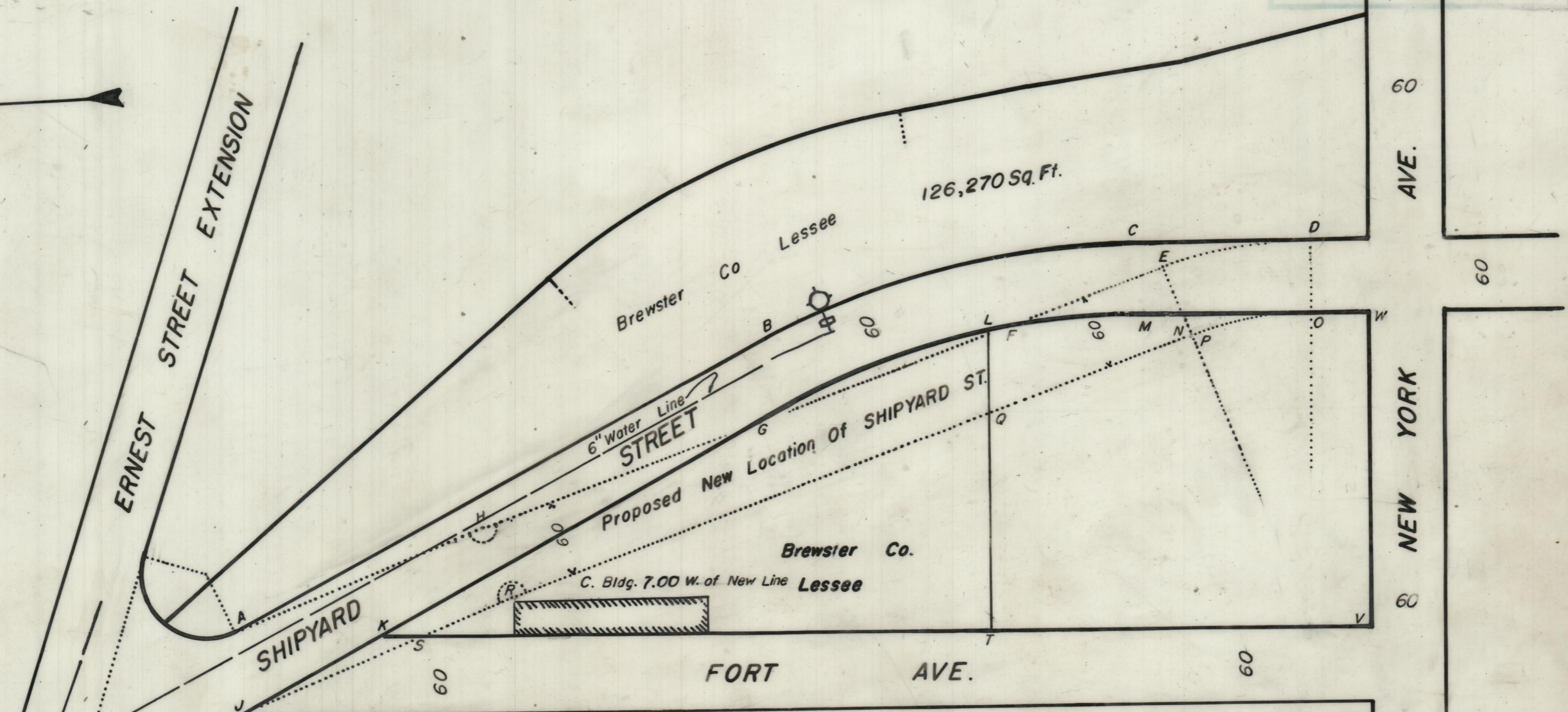

NOTES:-
AREA T-Q-P-O-W-V-T = 68,000± Sq. Ft.
K-G-L-Q-R-S-K = 26,700± Sq. Ft.
A-B-C-D-E-H-A = 31,200± Sq. Ft.

Proposed Revised Lease S-R-Q-T-S = 40,500± Sq. Ft.
Present Brewster Lease K-G-L-T-K = 62,779 Sq. Ft.
Brewster Co. Lease East of S. St. = 126,270 Sq. Ft.
Proposed Additional Lease (portion pres. S. St.) = 31,200± Sq. Ft.

CITY OF PROVIDENCE, R. I.
Public Works Dept. - Engineering Office
Showing Proposed Relocation Of
Shipyard St.
Drawn by Scungio Checked by L.P.R.
Scale 1" = 100' Date JUNE 1, 1966
Corrected by L. Reid
Approved Robert B. Strong