

PROVIDENCE, R. I.
 P. W. DEPT. - ENGINEERING OFFICE
 CITY PROPERTY SECTION
 Plan No. 062799
 Date AUGUST 12, 1965



BRIDGHAM ST.

AVE.

SHELL OIL CO.

ELMWOOD

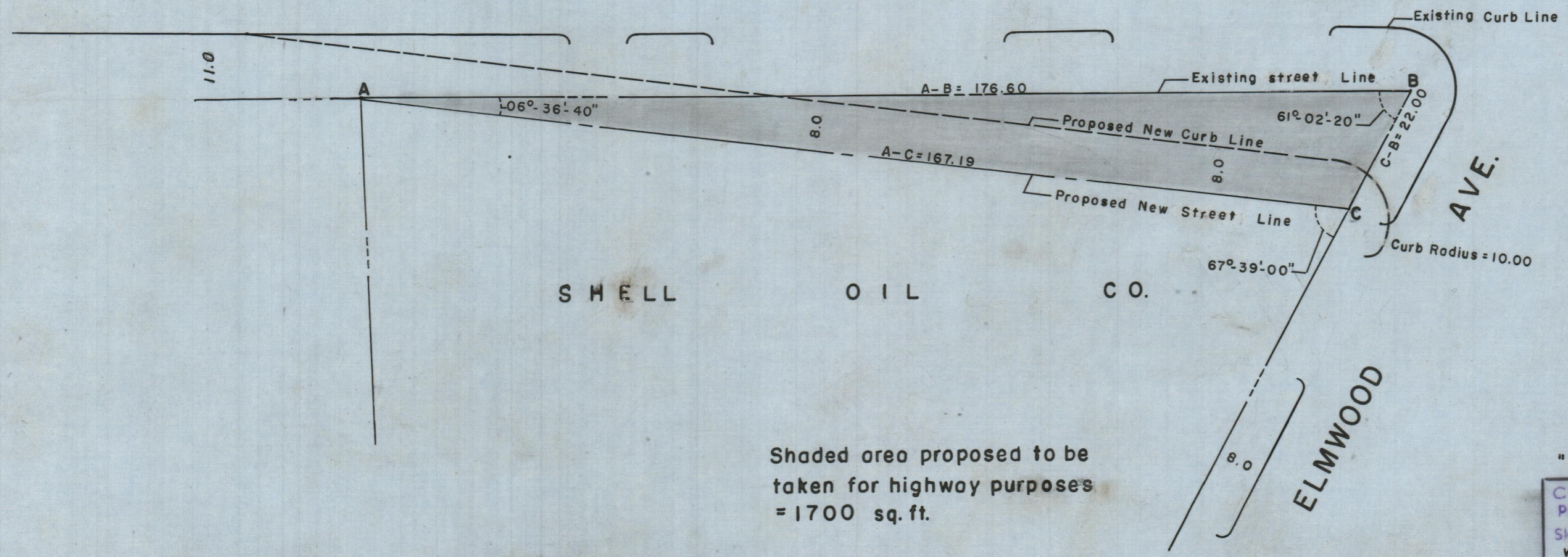

Shaded area proposed to be taken for highway purposes = 1700 sq. ft.

"REVISED PLAN"
 CITY OF PROVIDENCE, R. I.
 Public Works Dept. - Engineering Office
 Showing Land required for widening of Bridgham st.
 Drawn by G.F.J. Checked by L.P.R.
 Scale 1" = 20' Date
 Corrected by *R. B. Stong* Associate Engr.
 Approved *Robert B. Stong* CHIEF ENGINEER