

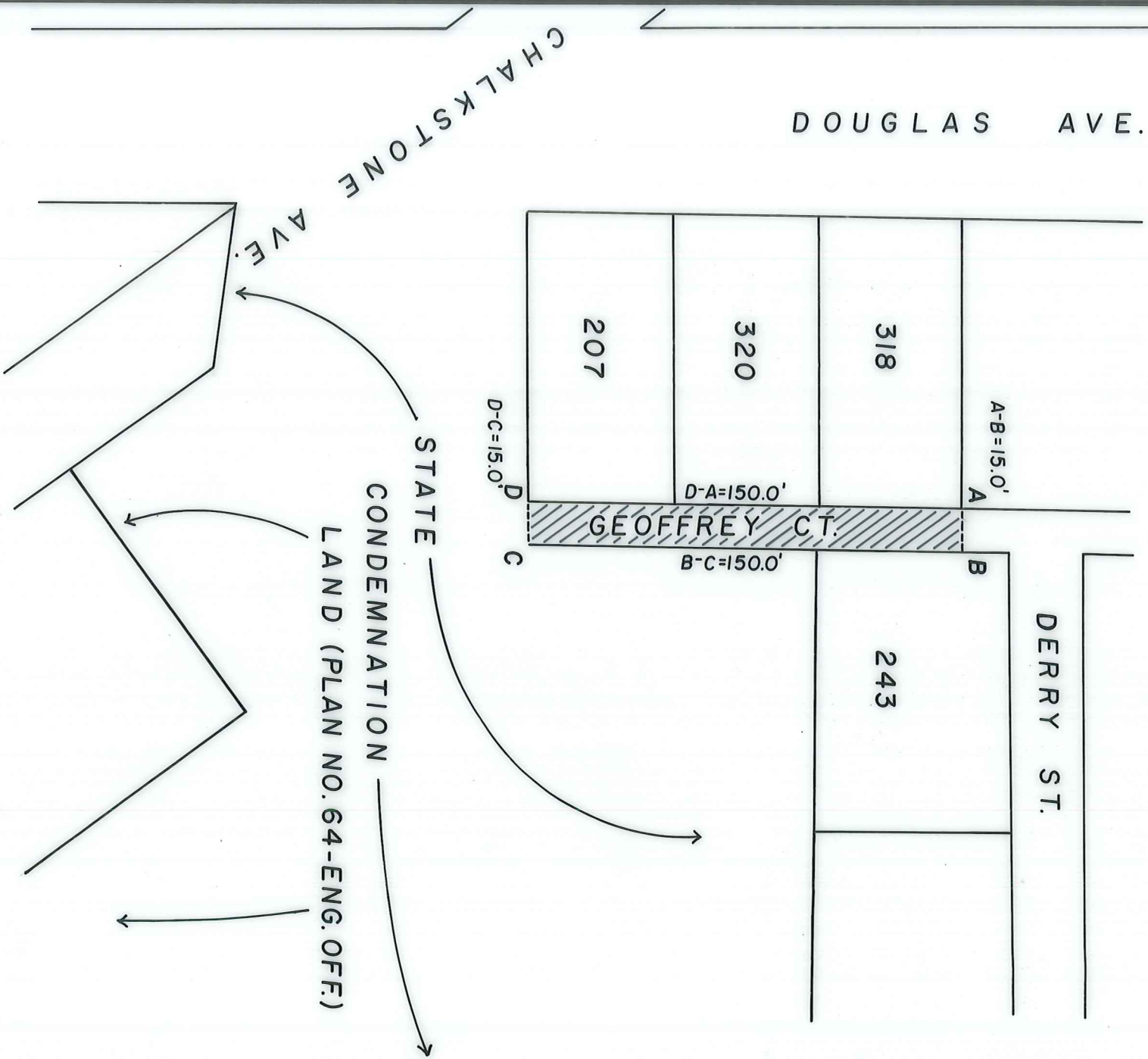

PROVIDENCE, R. I.
R. I. DEPT. OF ENGINEERING OFFICE
STREET LINE SECTION
Plan No. 064660
Date Mar. 22, 2001



NOTES: Cross-hatched area (A-B-C-D-A) indicates proposed abandonment.
Total square footage= 2,250.0'
No sewer easement required.

Lot numbers taken from A.P. 68.

CITY OF PROVIDENCE, R. I.
Public Works Dept. - Engineering Office
Showing proposed abandonment of a
portion of Geoffrey Court
Drawn by A. Zisides Checked by gpc
Scale 1" = 50' Date 3-22-01
Correct James P. Hunt Associate Eng.
Approved Amelia Stearns CHIEF ENG.
R.I.