

PROVIDENCE, R. I.
 P. W. DEPT. - ENGINEERING OFFICE
 CITY PROPERTY SECTION
 Plan No 062634
 Date March 4, 1964

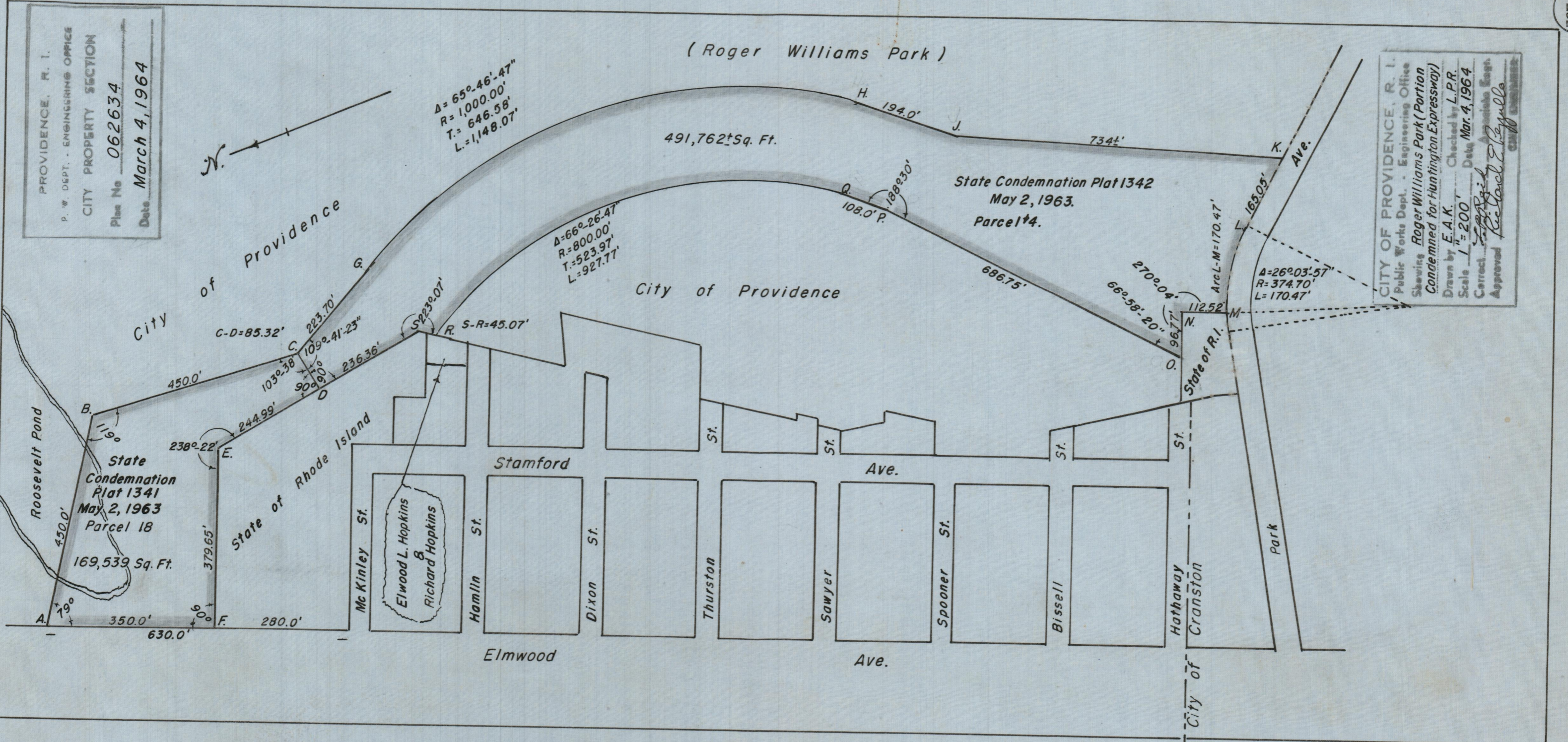

CITY OF PROVIDENCE, R. I.
 Public Works Dept. - Engineering Office
 Showing Roger Williams Park (Portion
 Condemned for Huntington Expressway)
 Drawn by E.A.K. Checked by L.P.R.
 Scale 1" = 200' Date Mar. 4, 1964
 Corrected by [Signature] Approved by Richard E. Reynolds