

PROVIDENCE, R. I.  
 P. W. DEPT. ENGINEERING OFFICE  
 CITY PROPERTY SECTION  
 Plan No. 062634  
 Date March 4, 1964

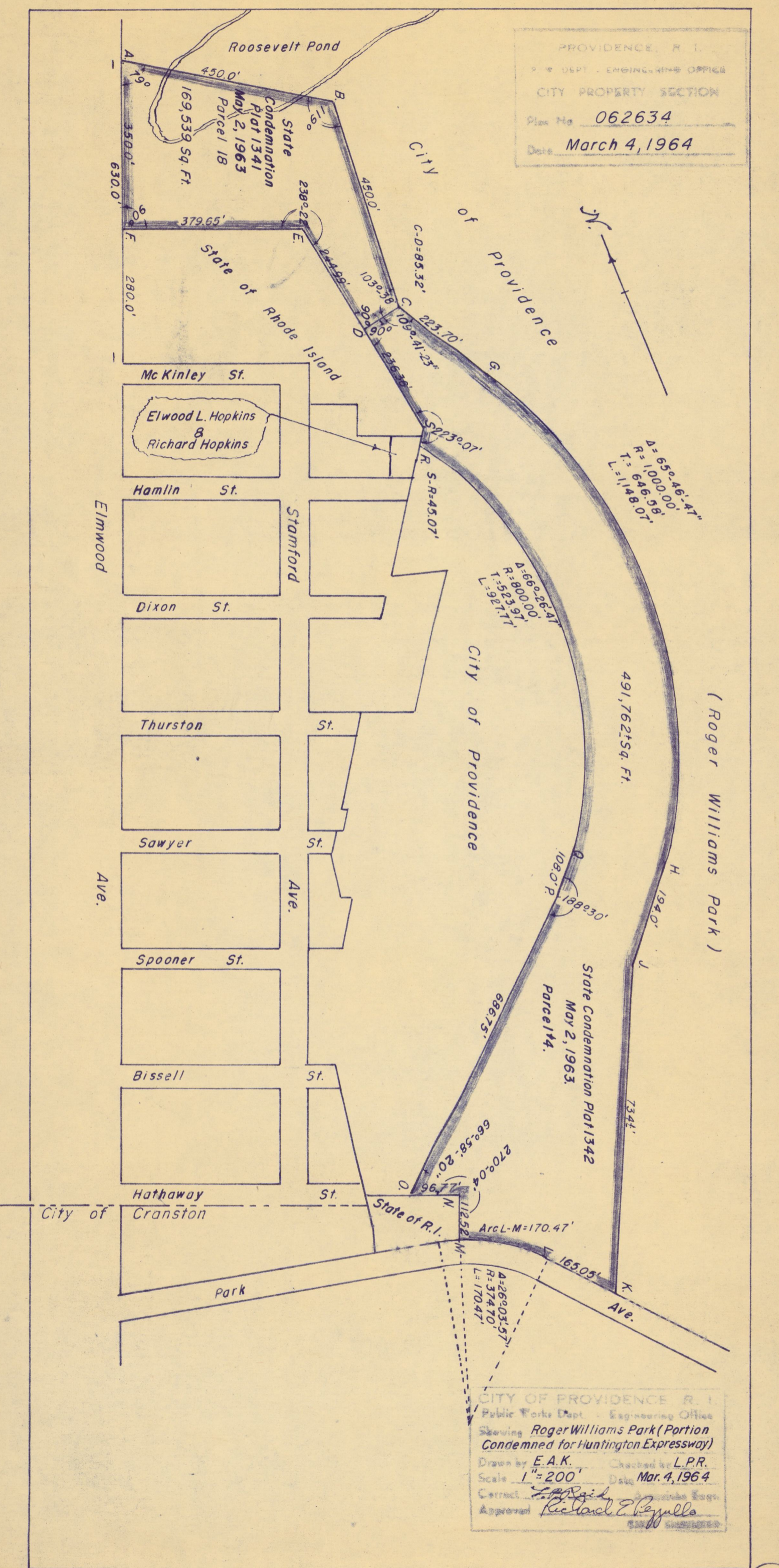

CITY OF PROVIDENCE R. I.  
 Public Works Dept. - Engineering Office  
 Showing Roger Williams Park (Portion  
 Condemned for Huntington Expressway)  
 Drawn by E.A.K. Checked by L.P.R.  
 Scale 1" = 200' Date Mar. 4, 1964  
 Corrected by [Signature]  
 Approved by Richard E. Reynolds