

Plan of Eaton Street.

from Douglas Ave. to Smith St.

Scale - 80 ft. - per inch.

City Engineers Office

January 29. 1876.

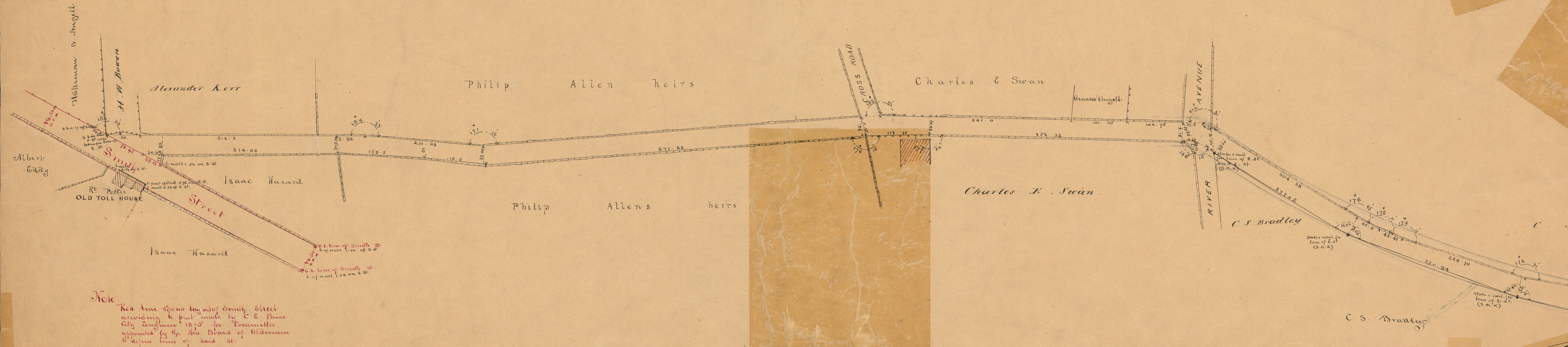

Note.
Red line shows layout of Smith Street according to plat made by C. E. Paine City Engineer, 1875, for Committee appointed by the Hon. Board of Aldermen to define lines of said St.