

STREET IMP PLANS
 City Engineer's Office
 No. 120
 NOT TO BE TAKEN FROM THE OFFICE.

April 27, 1874

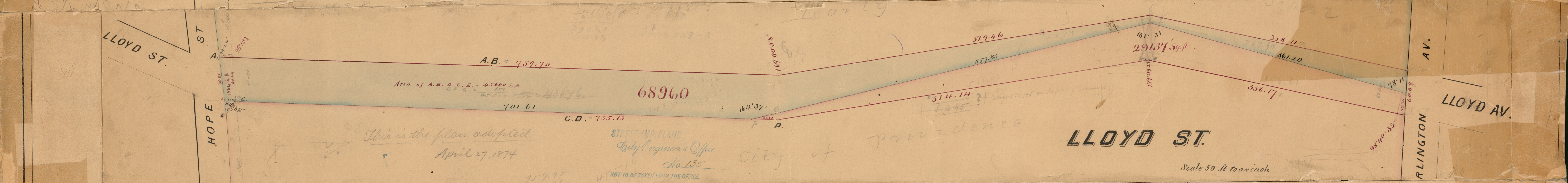

STREET IMP. PLANS
 City Engineer's Office
 No. 135
 NOT TO BE TAKEN FROM THE OFFICE.

This is the plan adopted
 April 27, 1874

City of Providence

LLOYD ST.

Scale 50 ft per inch

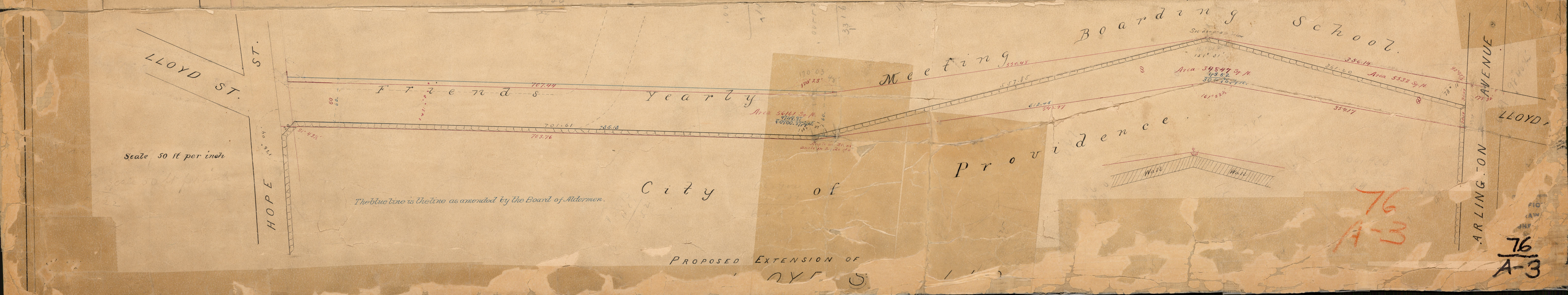

PROPOSED EXTENSION OF

City of Providence

City of Providence

Boarding School

The blue line is the line as amended by the Board of Aldermen.

76
 A-3

76
 A-3