

PROVIDENCE, R.I.  
CITY ENGINEER'S OFFICE  
STREET LINE DEPT.

June 27, 1906.

034518

Note, The area declared a public highway  
is indicated by the letters A, B, C and D.

The lines conform to deeds in Deed  
Books 436, page 9, 437, page 475, 439, page  
51, 440, page 7 and 444, page 430, in the  
office of the Recorder of Deeds.

# PLAT OF LONGMONT STREET

FROM ADMIRAL ST. TO SALINA ST.

SCALE 40 FEET PER INCH.  
DECLARED A PUBLIC HIGHWAY  
BY RESOLUTION OF THE  
BOARD OF ALDERMEN

April 19, 1906.

Witness, -----

City Clerk.

357.91  
355.00  
1712.91  
356.455

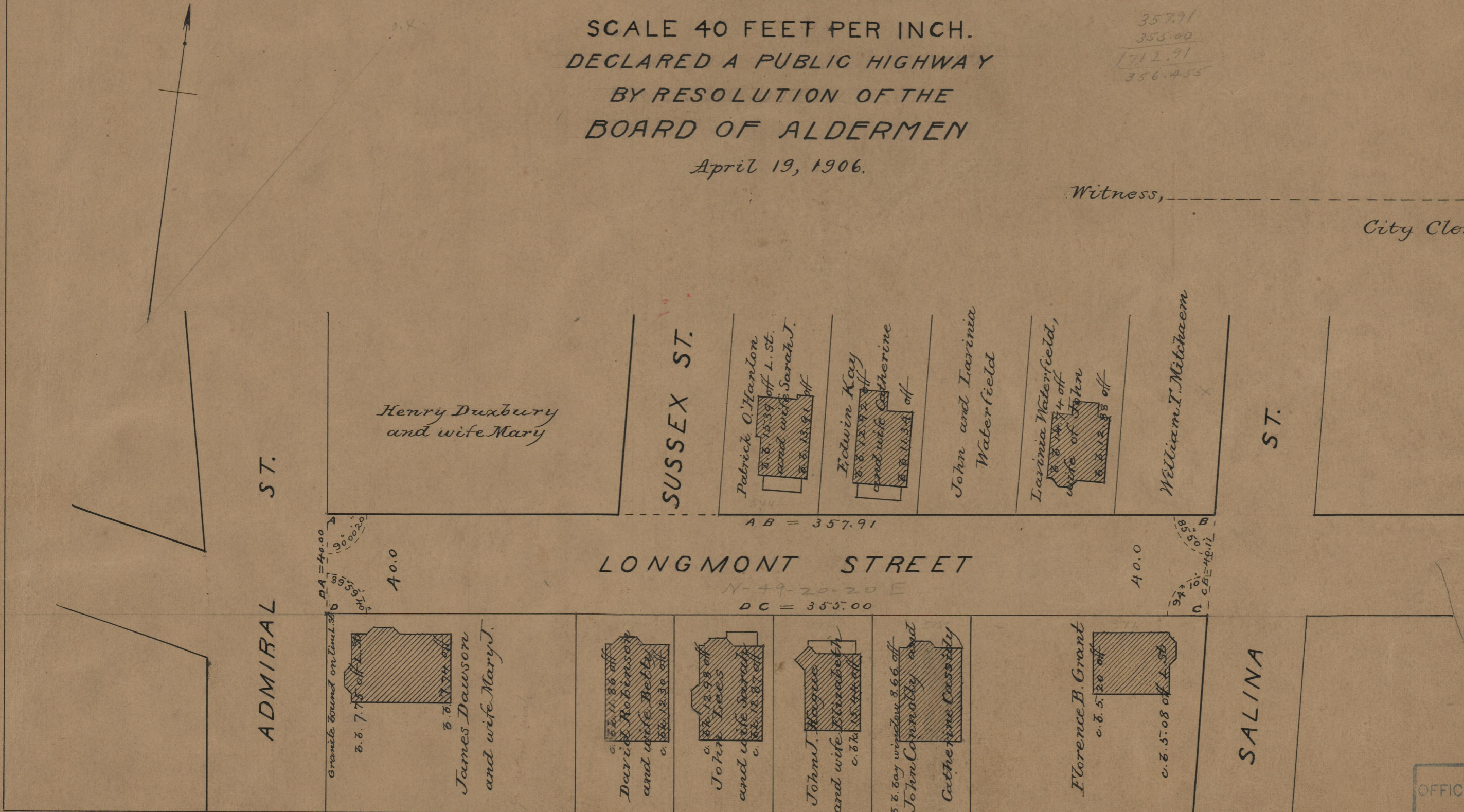

75  
B97

OFFICE No.	17286
DRAWER	75
SHEET	B - 97