

PROVIDENCE, R.I.  
CITY ENGINEER'S OFFICE  
STREET LINE DEPT.

Dec. 30 1905

034167

Note, The area declared a public highway  
is indicated by the letters A, B, C and D.  
The lines conform to deed in Deed Book 415,  
page 83, in the office of the Recorder of Deeds

# PLAT OF MASSIE AVENUE

FROM BROAD ST. TO BAXTER ST.  
SCALE 50 FEET PER INCH.

DECLARED A PUBLIC HIGHWAY  
BY RESOLUTION OF THE  
BOARD OF ALDERMEN  
October 19, 1905,

582.44  
571.45  
-----  
1153.89 ✓  
576.95

Witness, \_\_\_\_\_  
City Clerk.

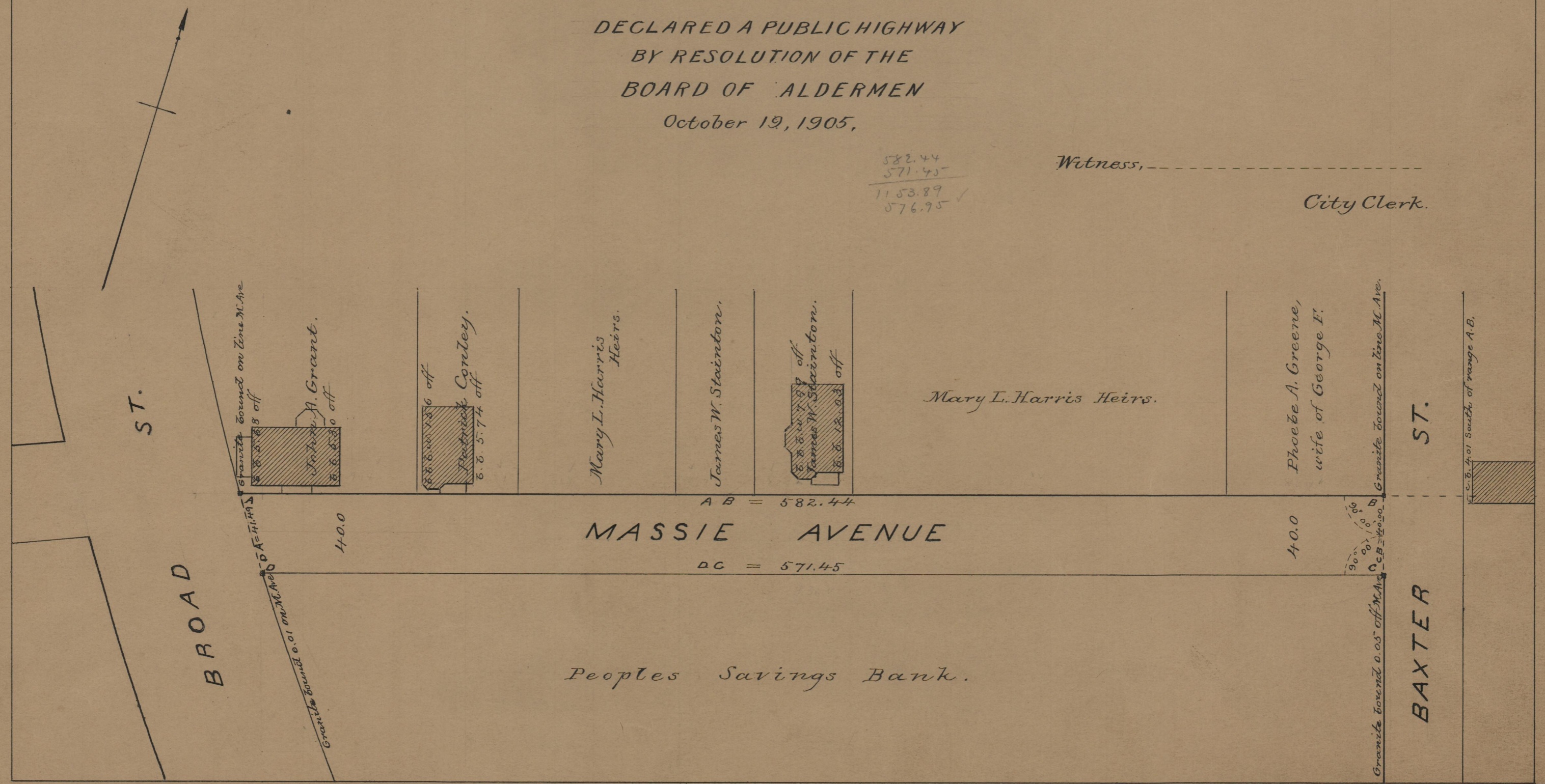

Peoples Savings Bank.

75  
B87

75  
B87

OFFICE No. 17202  
DRAWER " 75  
P-87