

PROVIDENCE, R.I.
CITY ENGINEER'S OFFICE
STREET LINE DEPT.

Dec. 21, 1905

034146

Note, The area declared a public highway is indicated by the letters A, B, C & D. The lines conform to deeds in Deed Books 373, page 465, 396, page 43, 467, page 61 and 468, page 262, in the office of the Recorder of Deeds

PLAT OF WAVERLY STREET

FROM CRANSTON ST. TO UNION AVE.

SCALE 60 FEET PER INCH.

DECLARED A PUBLIC HIGHWAY
BY RESOLUTION OF THE
BOARD OF ALDERMEN

Sept 21, 1905.

805.27
767.63
1572.90
786.45

Witness, _____

City Clerk, _____

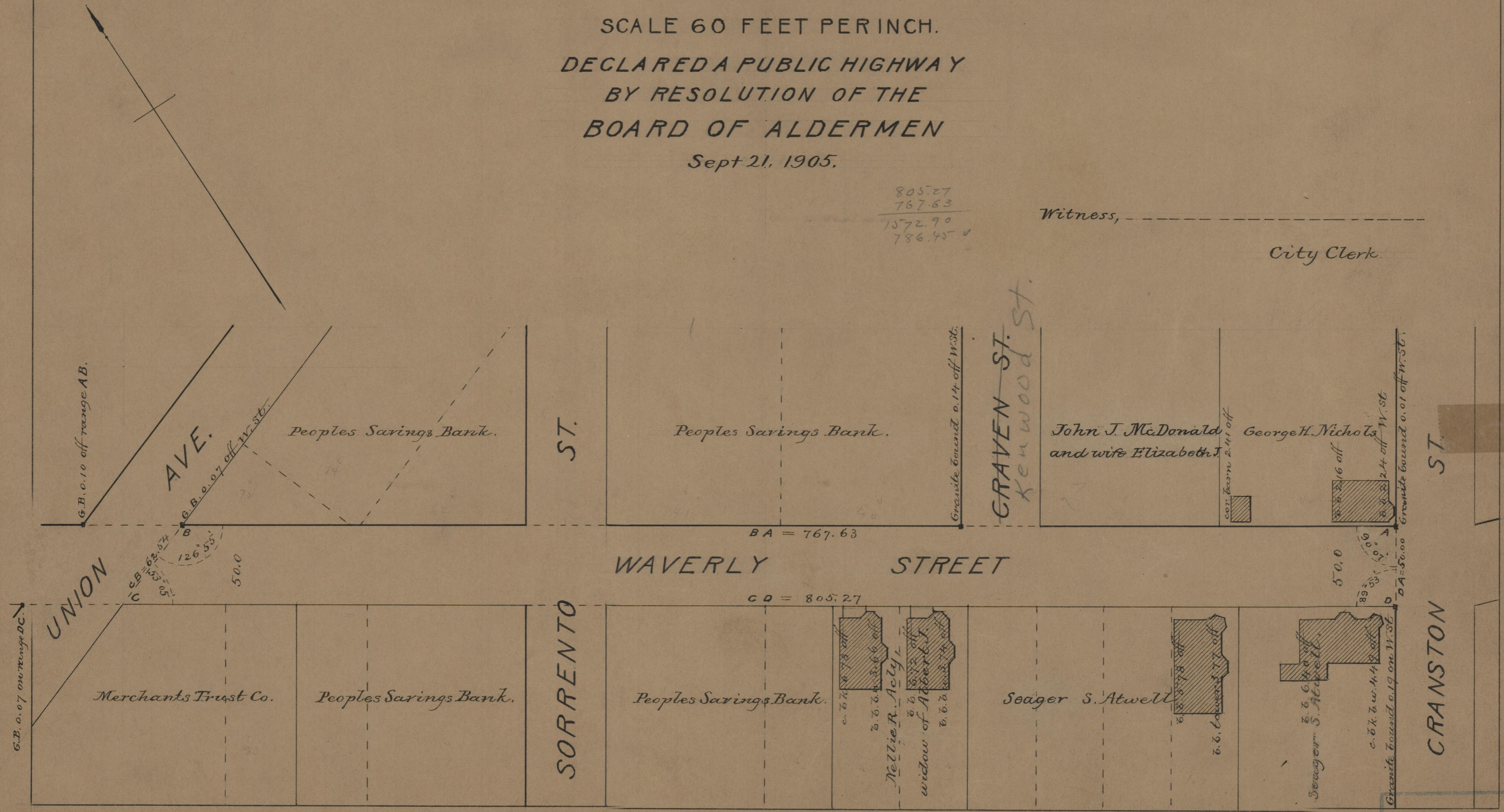

OFFICE No. 17198
DRAWER " 75
SHEET " B-83