

L.S. Duffee, Eng.

ESM XIX 170

PROVIDENCE, R.I.
CITY ENGINEER'S OFFICE

STREET LINE DEPT.

Mar. 11, 1903.

031414

PLAT OF

BELL STREET

FROM EISWALD ST. TO EASTERLY LINE OF BARRE ST.

SCALE 40 FEET PER INCH.

100.0

[Condemned By Olneyville Expressway]

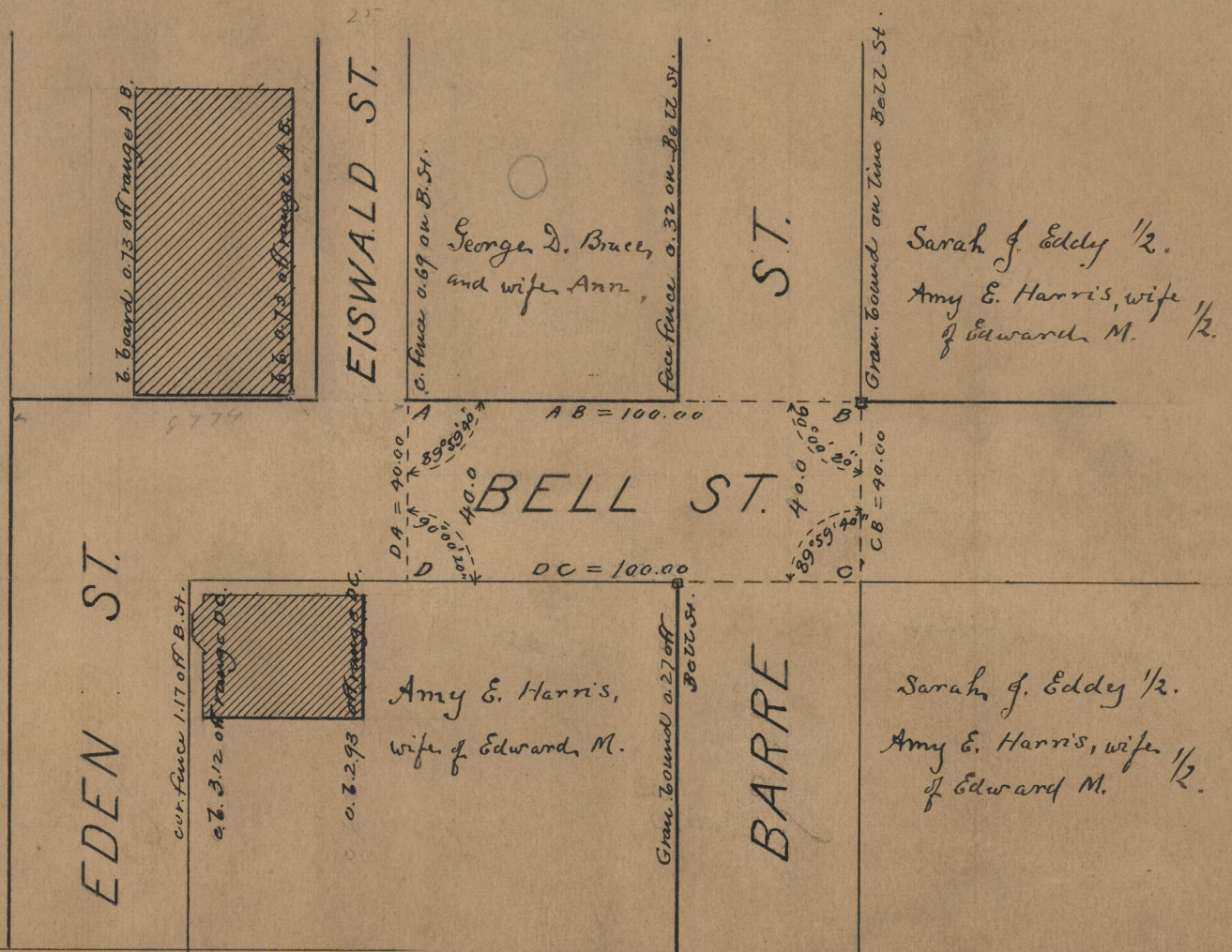
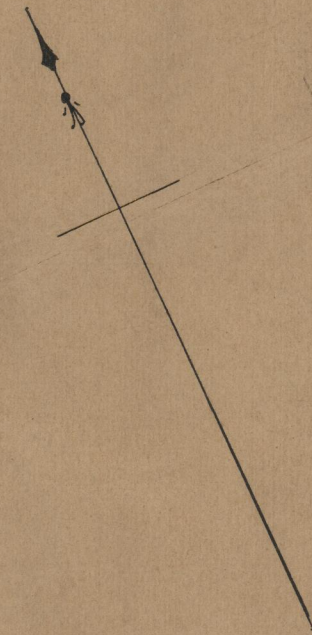

OFFICE No. 15039
 DRAWER " 75
 SHEET " 825