

PROVIDENCE, R.I.
CITY ENGINEER'S OFFICE

STREET LINE DEPT.

Aug. 21, 1901.

030295

Note. The area declared a public highway
is indicated by the letters ABCD.

The lines thus fixed agree with the deed
recorded in deed book 440 on page 316.

PLAT OF RHODE ISLAND AVENUE

FROM ANGELL ST. TO ORIOLE AVE.

SCALE 50 FEET PER INCH.

DECLARED A PUBLIC HIGHWAY
BY RESOLUTION OF THE
BOARD OF ALDERMEN,

August 5, 1901.

Changed to Parkside Road, June 16, 1904

Witness;

City Clerk.

199.92

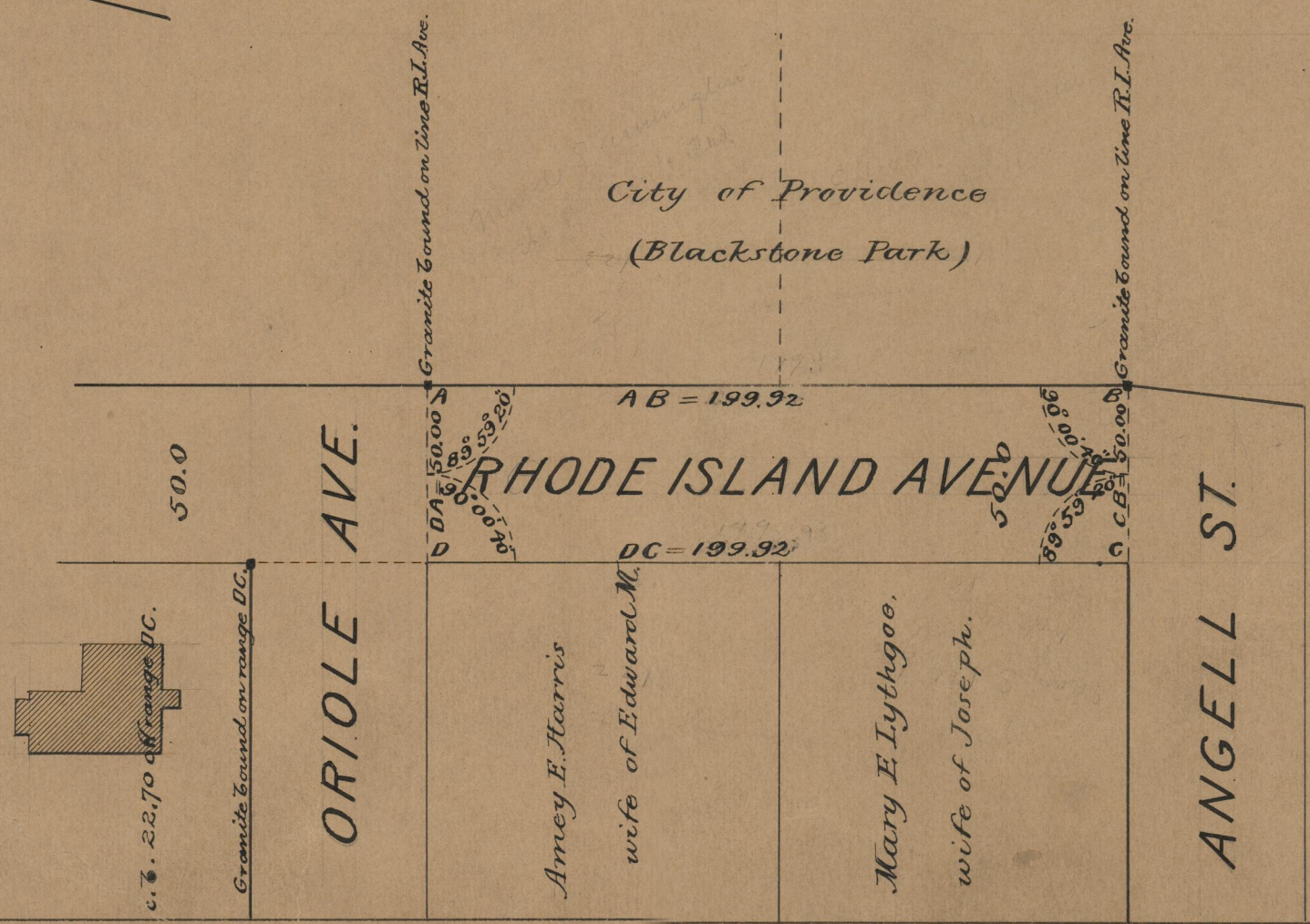

*75
A-74*

*75
A-74*

OFFICE No.	144
DRAWER	75
SHEET	A-74