

PLAT OF WOODBINE STREET

FROM NORTH MAIN ST. TO CAMP ST.

IN TWO SHEETS

SCALE 50 FEET PER INCH.

PROVIDENCE, R.I.
CITY ENGINEER'S OFFICE
STREET LINE DEPT.
June 22, 1901.
030168

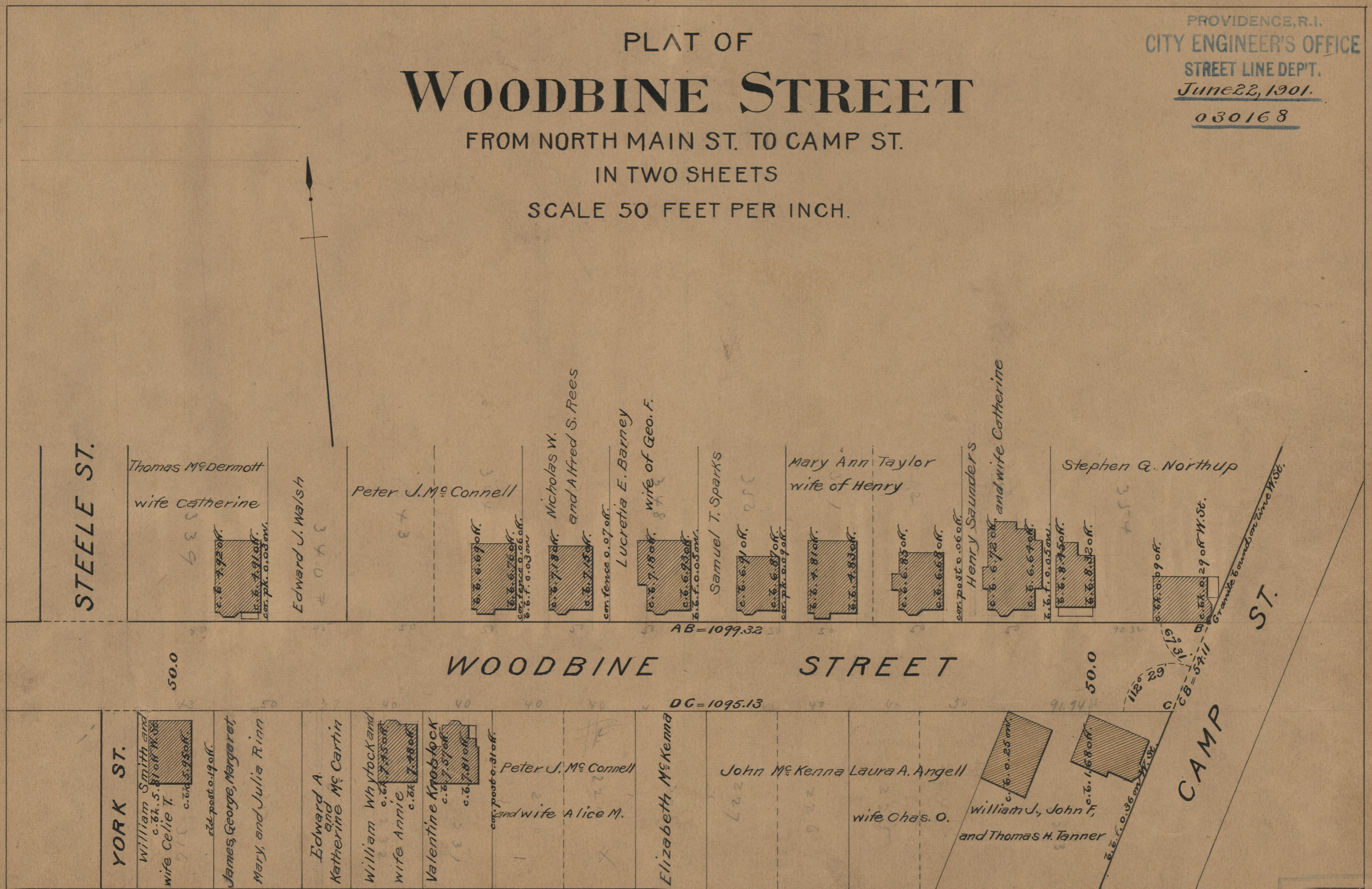
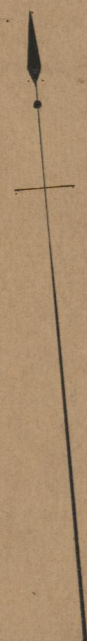

STEELE ST.

Thomas McDermott
wife Catherine

Edward J. Walsh

Peter J. Mc Connell

Nicholas W.
and Alfred S. Rees

Lucretia E. Barney
wife of Geo. F.

Samuel T. Sparks

Mary Ann Taylor
wife of Henry

Henry Saunders
and wife Catherine

Stephen G. Northup

YORK ST.

William Smith and
wife Celie T.

James George, Margaret,
Mary, and Julia Rinn

Edward A.
and Katherine Mc Cartin

William Whytock and
wife Annie

Valentine Knoblock

Peter J. Mc Connell
and wife Alice M.

Elizabeth Mc Kenna

John Mc Kenna
wife Chas. O.

William J., John F.
and Thomas H. Tanner

CAMP ST.

OFFICE NO. 14448
DRAWER 75
SHEET A-73