

Note, The tracts of land established as public highways are indicated hereon by the letters ABCDE and the letters FGHIJ.

PLAT OF TRACTS OF LAND ADJACENT TO MILL STREET BRIDGE,

(SCALE 20 FEET PER INCH),
ESTABLISHED AS PUBLIC HIGHWAYS, BY THE BOARD OF ALDERMEN,
November 15, 1900.

Red figures were taken Jan. 11, 1901.

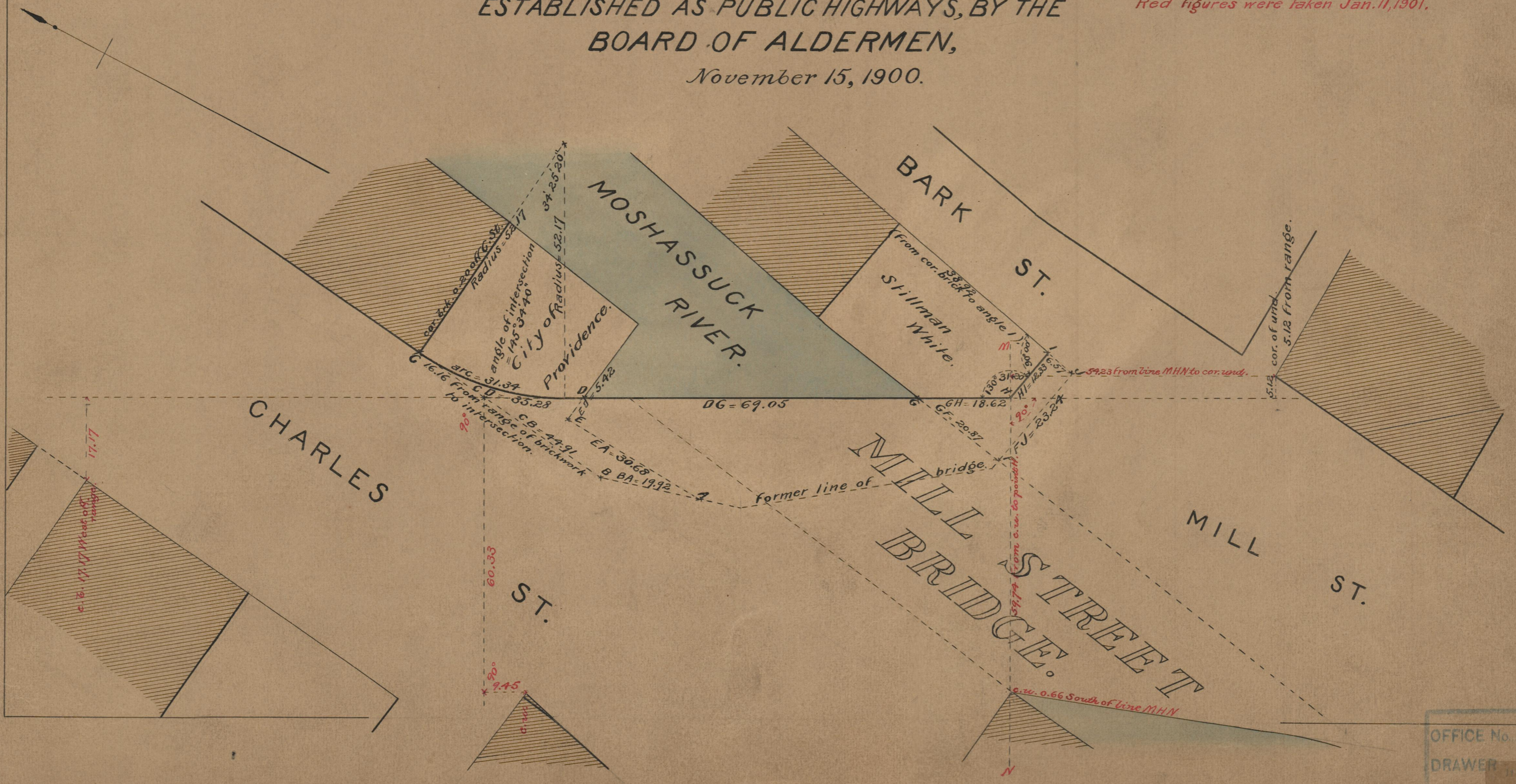

75
A-65

OFFICE No. 14200
DRAWER 75
SHEET A-65