

IN THREE SHEETS  
SHEET THREE

MAP OF THE PORTION OF  
**PARK AVENUE**  
WITHIN THE LIMITS OF THE CITY OF PROVIDENCE.  
SCALE 60 FEET PER INCH  
DECLARED A PUBLIC HIGHWAY  
BY RESOLUTION OF THE  
BOARD OF ALDERMEN  
October 1, 1896.

PROVIDENCE, R.I.  
CITY ENGINEER'S OFFICE  
STREET LINE DEPT.  
Oct. 21, 1896  
025698

Note. The lines of Park Avenue indicated by the letters ABCD etc, correspond with the deeds on record in the Town Clerk's office in Cranston in deed book 69 pages 77, 91 and 92.

Note-Annexed to Cranston April 11, 1907.

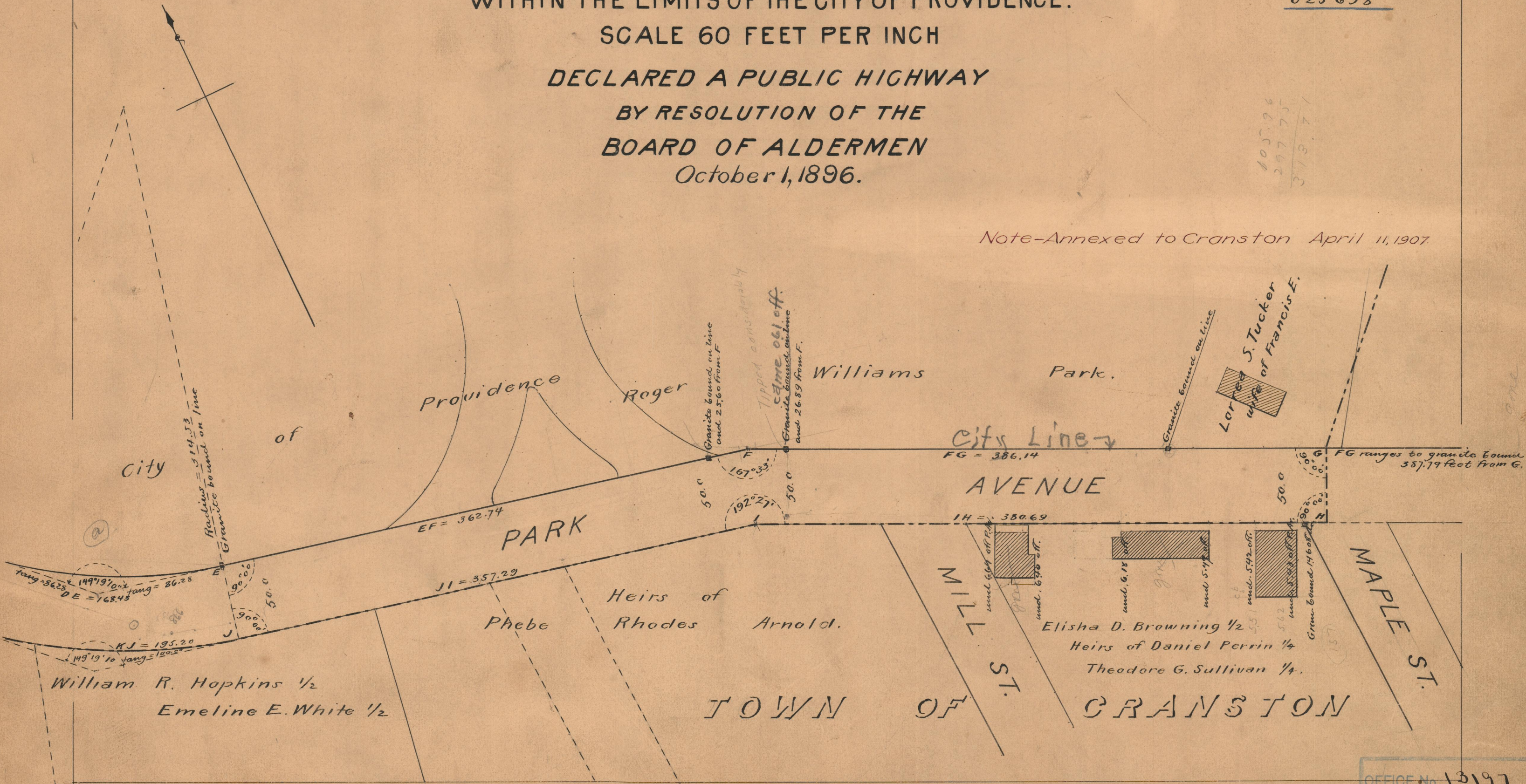

OFFICE No. 13197  
DRAWER " 75  
SHEET " A-10