

MAP OF EAST RIVER STREET, AND OF WATERMAN & PITMAN STREETS

Made by order of Chas. Anthony, Saml. I. Blaisdell, & Wm. S. Haines;
A COMMITTEE APPOINTED TO LAY OUT THE SAME BY THE BOARD OF ALDERMEN.

By Wm. S. Haines;
OCT. 15th 1874.

Scale 60 ft per inch
Meas'd in U.S. Standard ft.

This map forms a part of our report to the Honorable Board of Aldermen of the City of Providence, September 15, 1874, as on above date mentioned. Providence Oct. 15, 1874.

Charles Anthony
Saml. I. Blaisdell
Wm. S. Haines

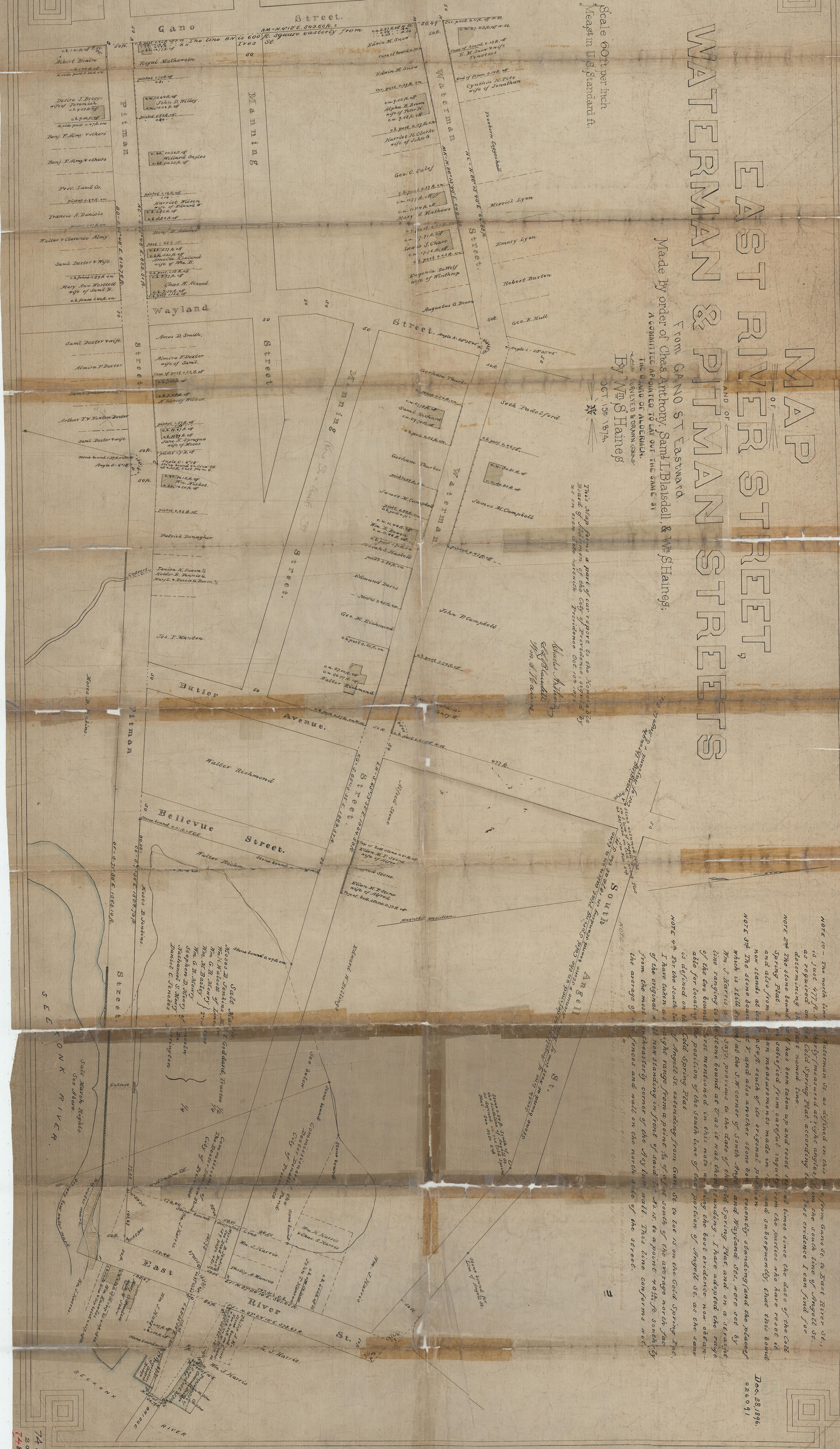

NOTE 1st - The north line is just 47 1/2 ft. as measured at right angles from the south line of Angell St. as requested on the plan of the Cold Spring Place, according to the best evidence I can find for determining the true north line.

NOTE 2nd - The stone bound on the north line of Cold Spring Place, I have measured from the parties who have reset it, and also from the original measurements made in 1822 and subsequently, that the bound now stands at the same position as the original position.

NOTE 3rd - The stone bound at the corner of South Angell and Wayland Sts. were set by Mr. J. Harris in 1822, and also another stone bound at the corner of South Angell and Cold Spring Place.

NOTE 4th - For the south line of Angell St. extending from Gano St. to lot 15 on the Cold Spring Place, I have taken a range from a point 75 ft. of lot 15 south of the carriage north line of the original north line of the Cold Spring Place, as it was then standing. I have adopted the range from the most easterly corner of the lot 15 wall. This line conforms with the coverage of a fence and wall on the north side of the street.

NOTE 5th - The stone bound on the north line of Cold Spring Place, I have measured from the parties who have reset it, and also from the original measurements made in 1822 and subsequently, that the bound now stands at the same position as the original position.

NOTE 6th - The stone bound on the north line of Cold Spring Place, I have measured from the parties who have reset it, and also from the original measurements made in 1822 and subsequently, that the bound now stands at the same position as the original position.

NOTE 7th - The stone bound on the north line of Cold Spring Place, I have measured from the parties who have reset it, and also from the original measurements made in 1822 and subsequently, that the bound now stands at the same position as the original position.

NOTE 8th - The stone bound on the north line of Cold Spring Place, I have measured from the parties who have reset it, and also from the original measurements made in 1822 and subsequently, that the bound now stands at the same position as the original position.

NOTE 9th - The stone bound on the north line of Cold Spring Place, I have measured from the parties who have reset it, and also from the original measurements made in 1822 and subsequently, that the bound now stands at the same position as the original position.

NOTE 10th - The stone bound on the north line of Cold Spring Place, I have measured from the parties who have reset it, and also from the original measurements made in 1822 and subsequently, that the bound now stands at the same position as the original position.

NOTE 11th - The stone bound on the north line of Cold Spring Place, I have measured from the parties who have reset it, and also from the original measurements made in 1822 and subsequently, that the bound now stands at the same position as the original position.

NOTE 12th - The stone bound on the north line of Cold Spring Place, I have measured from the parties who have reset it, and also from the original measurements made in 1822 and subsequently, that the bound now stands at the same position as the original position.

NOTE 13th - The stone bound on the north line of Cold Spring Place, I have measured from the parties who have reset it, and also from the original measurements made in 1822 and subsequently, that the bound now stands at the same position as the original position.

NOTE 14th - The stone bound on the north line of Cold Spring Place, I have measured from the parties who have reset it, and also from the original measurements made in 1822 and subsequently, that the bound now stands at the same position as the original position.

NOTE 15th - The stone bound on the north line of Cold Spring Place, I have measured from the parties who have reset it, and also from the original measurements made in 1822 and subsequently, that the bound now stands at the same position as the original position.

NOTE 16th - The stone bound on the north line of Cold Spring Place, I have measured from the parties who have reset it, and also from the original measurements made in 1822 and subsequently, that the bound now stands at the same position as the original position.

NOTE 17th - The stone bound on the north line of Cold Spring Place, I have measured from the parties who have reset it, and also from the original measurements made in 1822 and subsequently, that the bound now stands at the same position as the original position.

NOTE 18th - The stone bound on the north line of Cold Spring Place, I have measured from the parties who have reset it, and also from the original measurements made in 1822 and subsequently, that the bound now stands at the same position as the original position.

NOTE 19th - The stone bound on the north line of Cold Spring Place, I have measured from the parties who have reset it, and also from the original measurements made in 1822 and subsequently, that the bound now stands at the same position as the original position.

Dec. 28, 1896.
026091