

Feb. 24, 1926
048460

Oaklands Plat No 4

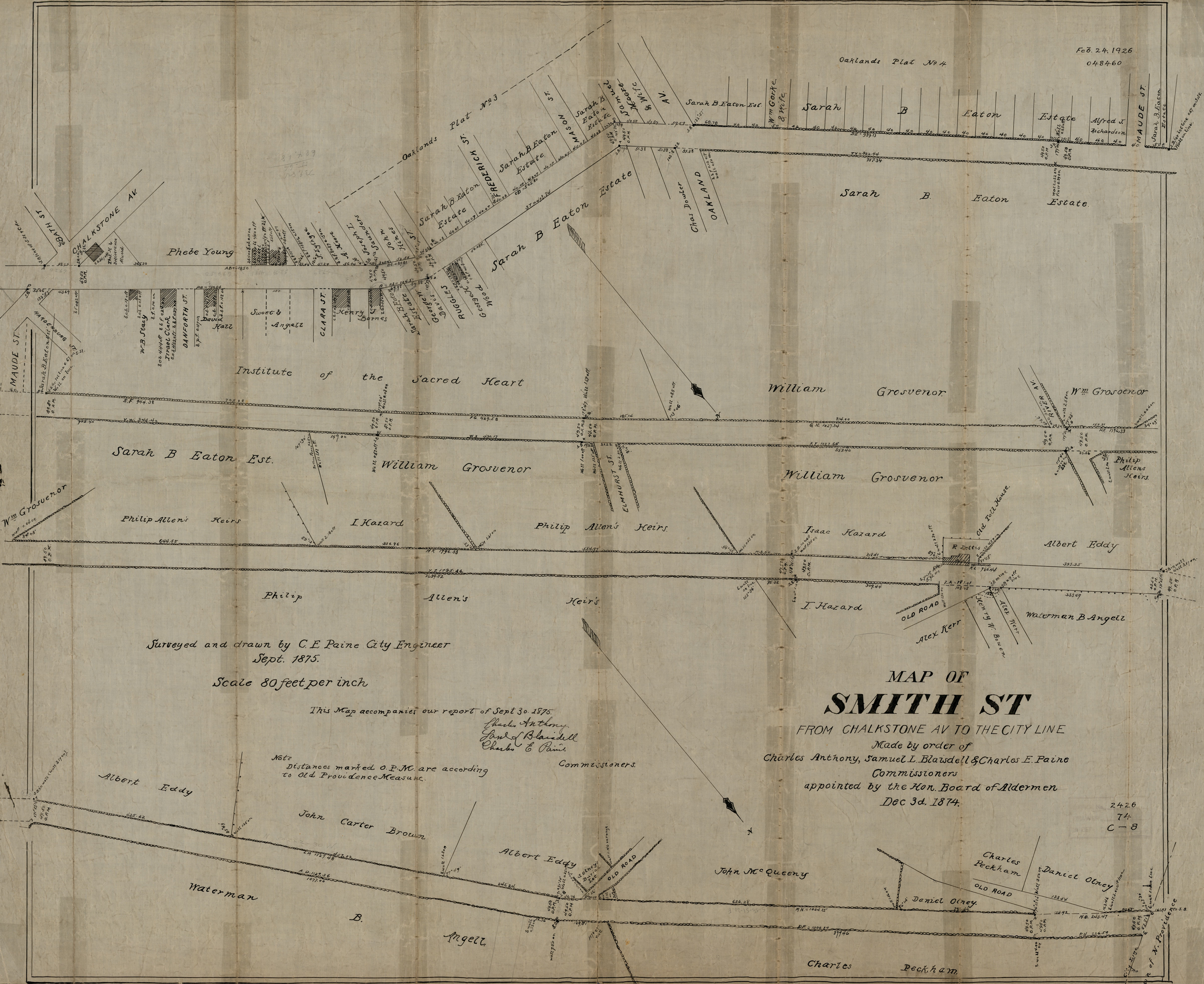

Surveyed and drawn by C.E. Paine City Engineer
Sept. 1875.

Scale 80 feet per inch

This Map accompanies our report of Sept 30, 1875.

Charles Anthony
Samuel L. Blaisdell
Charles E. Paine
Commissioners.

Note
Distances marked O.P.M. are according
to Old Providence Measure.

MAP OF SMITH ST

FROM CHALKSTONE AV TO THE CITY LINE

Made by order of
Charles Anthony, Samuel L. Blaisdell & Charles E. Paine
Commissioners
appointed by the Hon. Board of Aldermen
Dec 3d, 1874.

2426
74
C-8