

MAP OF

CHARLES ST

MISCELLANEOUS DEPT
June 28, 1901
030199

Scale 50 feet per inch

This Map accompanies our report of Dec. 15, 1875,

Charles Anthony,
Samuel L. Blaisdell,
Charles E. Paine

Commissioners

Surveyed and platted Dec. 1875
by C. E. Paine, City Engineer

FROM RANDALL SQUARE TO THE CITY LINE

Made by order of
Charles Anthony, Samuel L. Blaisdell and Charles E. Paine
Commissioners,

appointed by the Hon Board of Aldermen
Oct. 7, 1874

4 SHEETS

SHEET 2

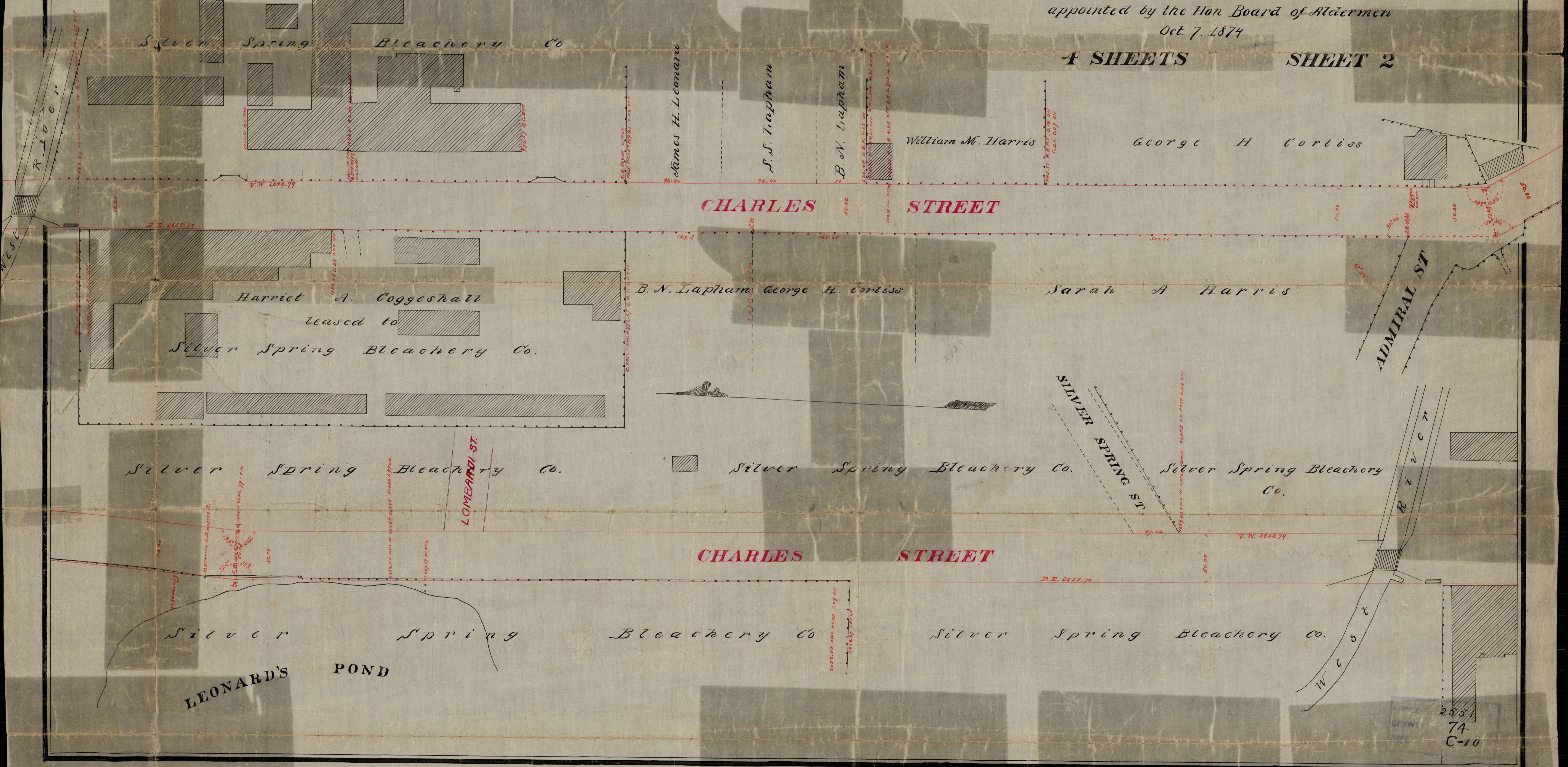

OFFICE No. 3551
DRAWN 74
SCALE C-10