

See note on Sheet One.

PLAT OF

RIVER AVENUE

FROM EATON ST. TO ADMIRAL ST.

IN THREE SHEETS

SCALE 60 FEET PER INCH

Declared a Public Highway
By Resolution of the
Board of Aldermen
November 3, 1921

CITY ENGINEER'S OFFICE
STREET LINE DEPT.
February 4, 1931
053373

Witness, City Clerk

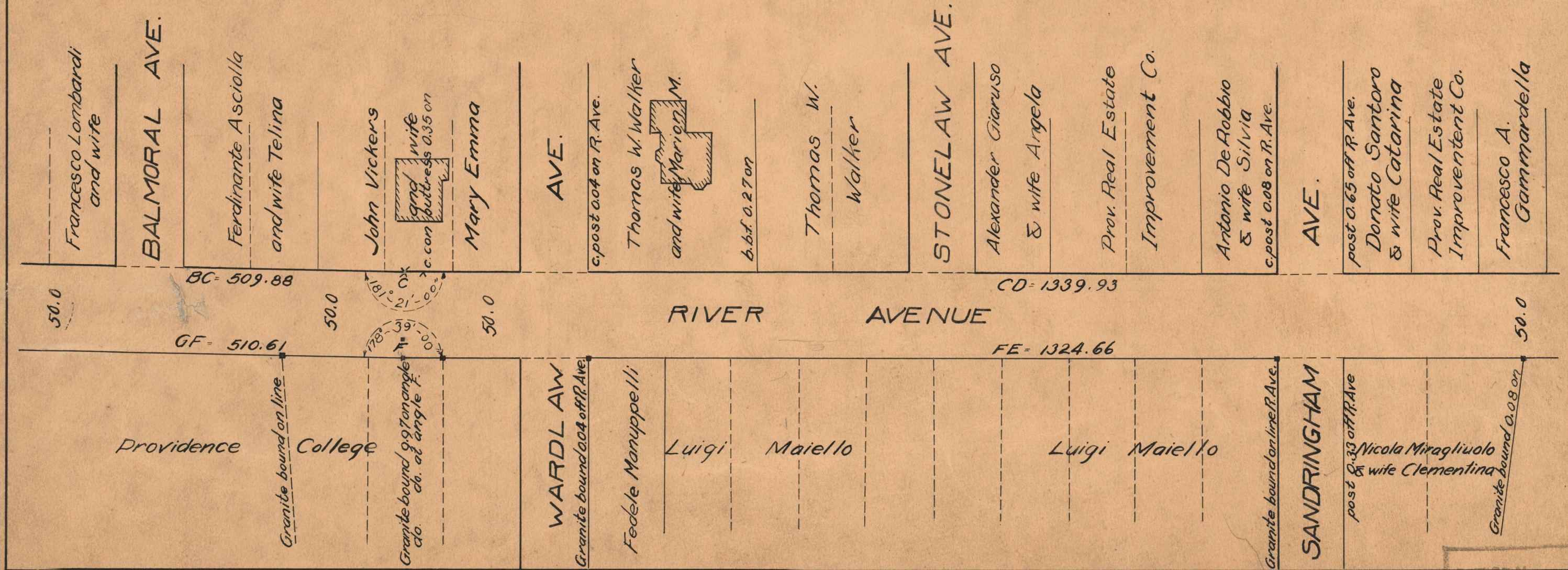

OFFICE No. 22246
 DRAWER 74
 SHEET B 93