

PROVIDENCE, R.I.  
CITY ENGINEER'S OFFICE  
STREET LINE DEPT.  
Oct. 31, 1927.  
050026

Note: The area declared a public highway is indicated by the letters A.B.C.D.  
The lines thus fixed agree with the deeds recorded in Deed Book 409, page 494, Deed Book 410, page 184, and Deed Book 595, page 385, in the office of the Recorder of Deeds.

# PLAT OF WARRINGTON STREET

FROM THE EASTERLY LINE OF  
NIAGARA ST. TO MELROSE ST.  
IN TWO SHEETS

SCALE 50 FEET PER INCH

DECLARED A PUBLIC HIGHWAY BY RESOLUTION  
OF THE BOARD OF ALDERMEN  
JANUARY 20, 1921

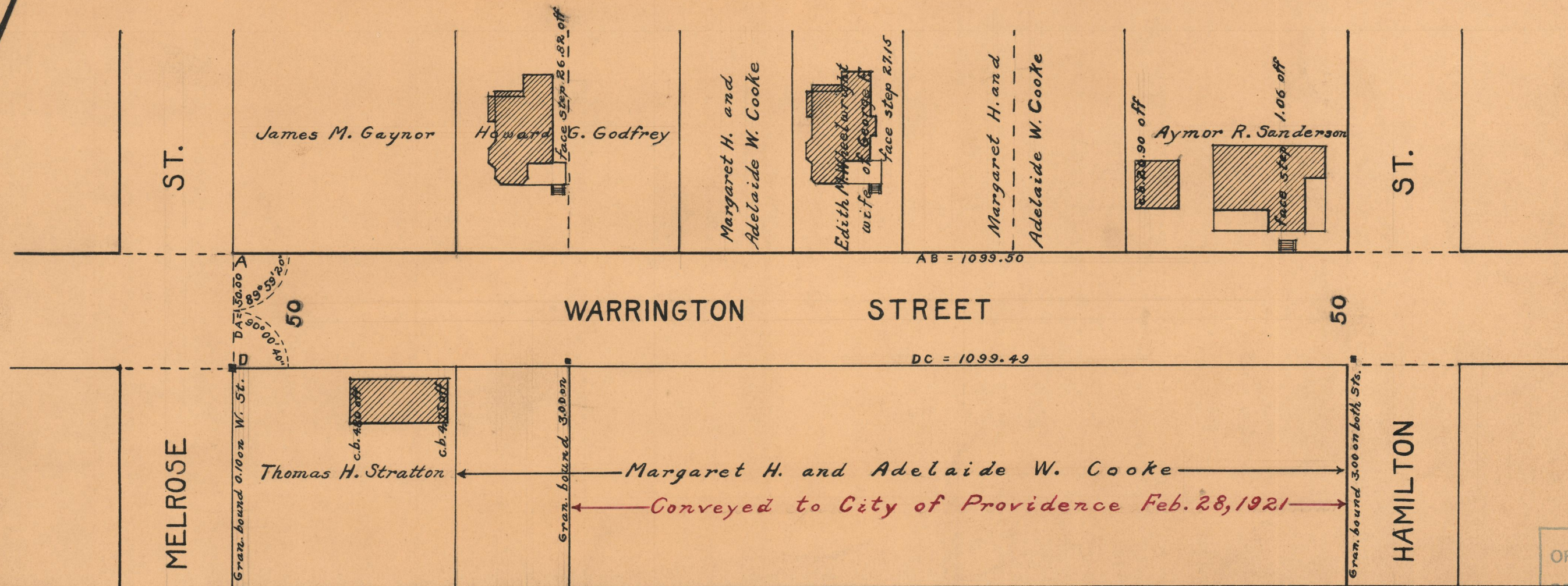
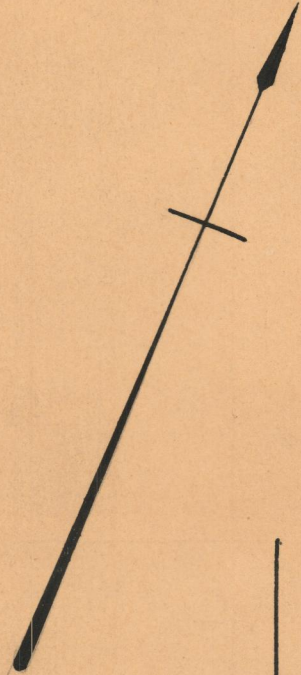

OFFICE No. 21937  
DRAWER " 74  
SHEET " B-68