

PROVIDENCE, R.I.  
CITY ENGINEER'S OFFICE  
STREET LINE DEPT.  
Dec 31, 1918

643653

# PLAT OF OVERHILL ROAD

FROM HOPE ST. TO THE EASTERLY  
LINE OF BAYARD ST.  
SCALE 40 FEET PER INCH.

Declared a Public Highway  
by Resolution of the  
Board of Aldermen  
December 5, 1918.

118.00  
160.25  
163.89  
119.00  
2561.14  
280.57

Note. The area declared a public highway  
is indicated by the letters A B C D E F.  
The lines thus fixed conform to the  
deed recorded in Deed book 528, page 447,  
in the office of the Recorder of Deeds.

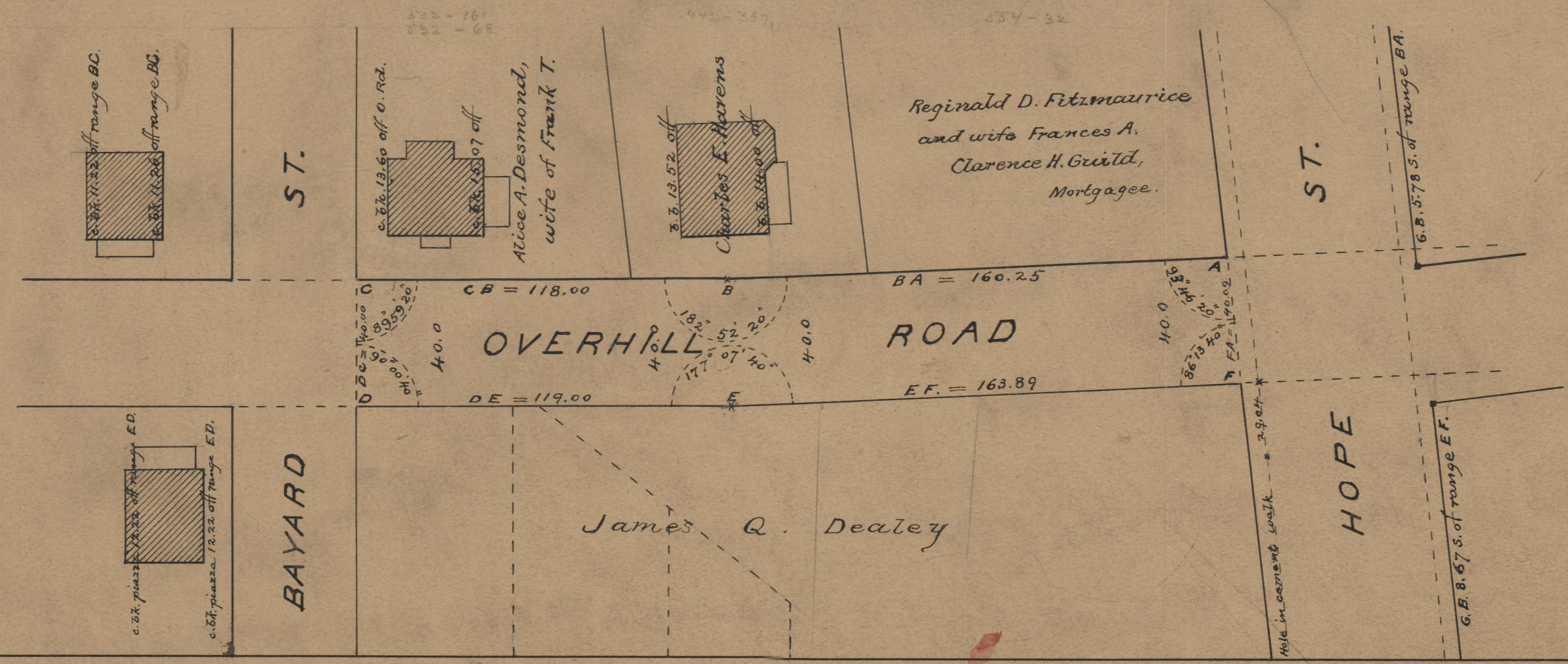
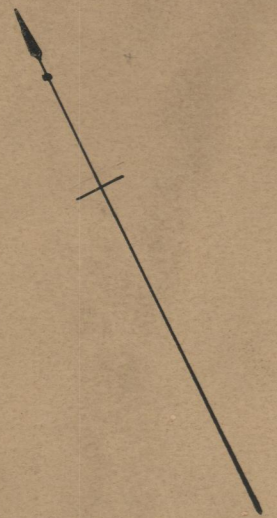

74  
B-28

OFFICE No. 21329  
DRAWER 74  
SHEET B-28