

PROVIDENCE, R.I.  
CITY ENGINEER'S OFFICE  
STREET LINE DEPT.

Dec. 22, 1916

042425

PLAT OF A  
**PARCEL OF LAND**

AT THE NORTHEASTERLY CORNER  
OF WATERMAN AND BENEFIT STS.  
SCALE 20 FEET PER INCH.

Declared a Public Highway  
by Resolution of the  
Board of Aldermen,  
September 7, 1916.

Witness, \_\_\_\_\_  
City Clerk.

Note, The area declared a public highway  
is indicated by the letters A B C.

The lines thus fixed conform to the plan  
numbered 042052 and to the deed re-  
corded in Deed book 558, page 462, in the  
office of the Recorder of Deeds.

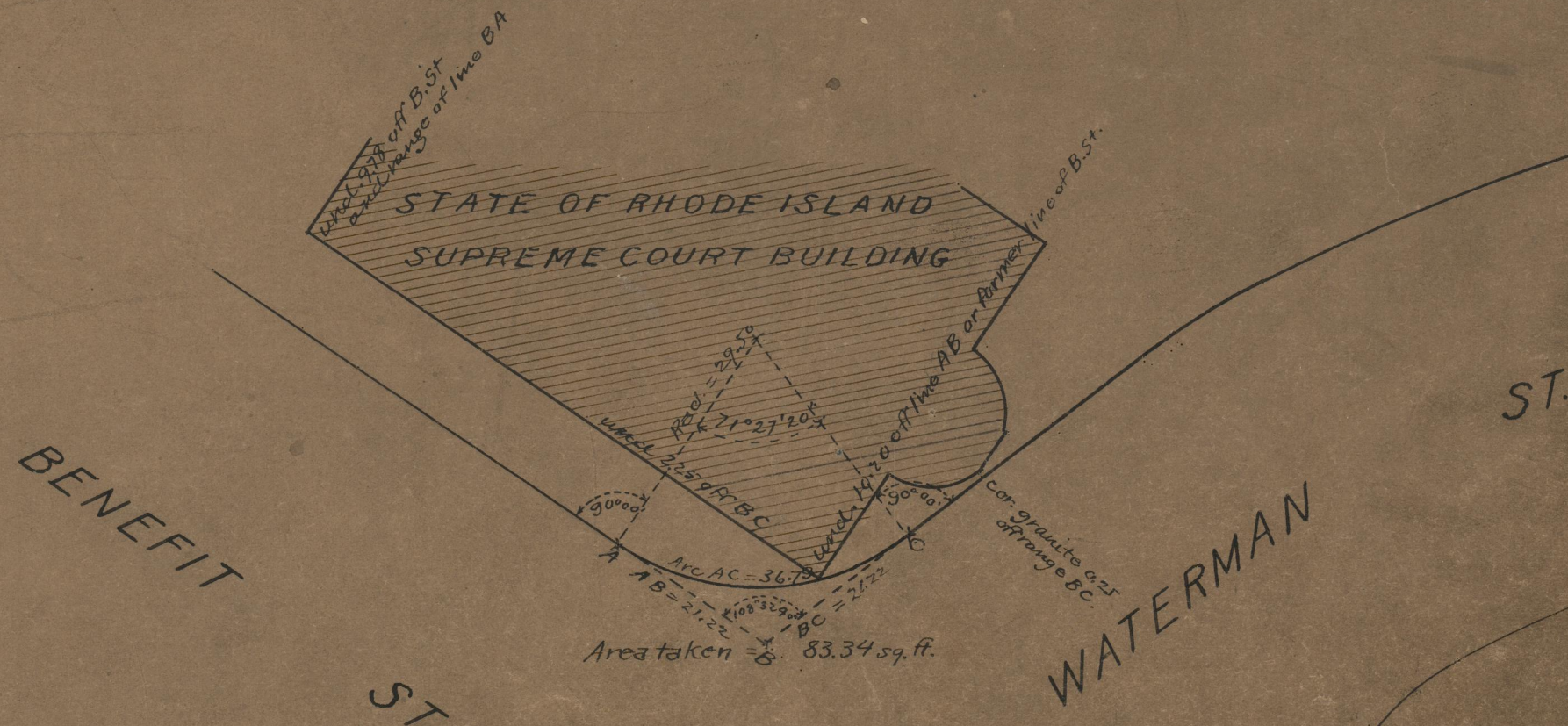

B1

74  
B-1

74  
B-1