

PROVIDENCE, R.I.
CITY ENGINEER'S OFFICE
STREET LINE DEPT.

Dec. 5, 1916

042375-4

PLAT OF LONGFELLOW STREET

FROM ELMWOOD AVE.
TO LAND OF N.Y., N.H. & H. R. R. CO.
SCALE 40 FEET PER INCH.

Declared a Public Highway
by Resolution of the
Board of Aldermen,
September 21, 1916.

Note, The area declared a public highway
is indicated by the letters A B C D.
The lines thus fixed conform to the deed
recorded in Deed book 376 at page 207 in
the office of the Recorder of Deeds.

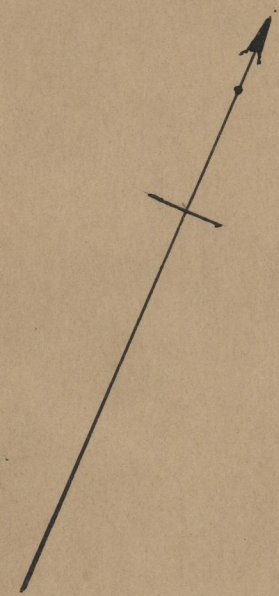

277.07
279.30
2556.37
278.185

Witness, -----
City Clerk.

New York, New Haven and Hartford R.R. Co.

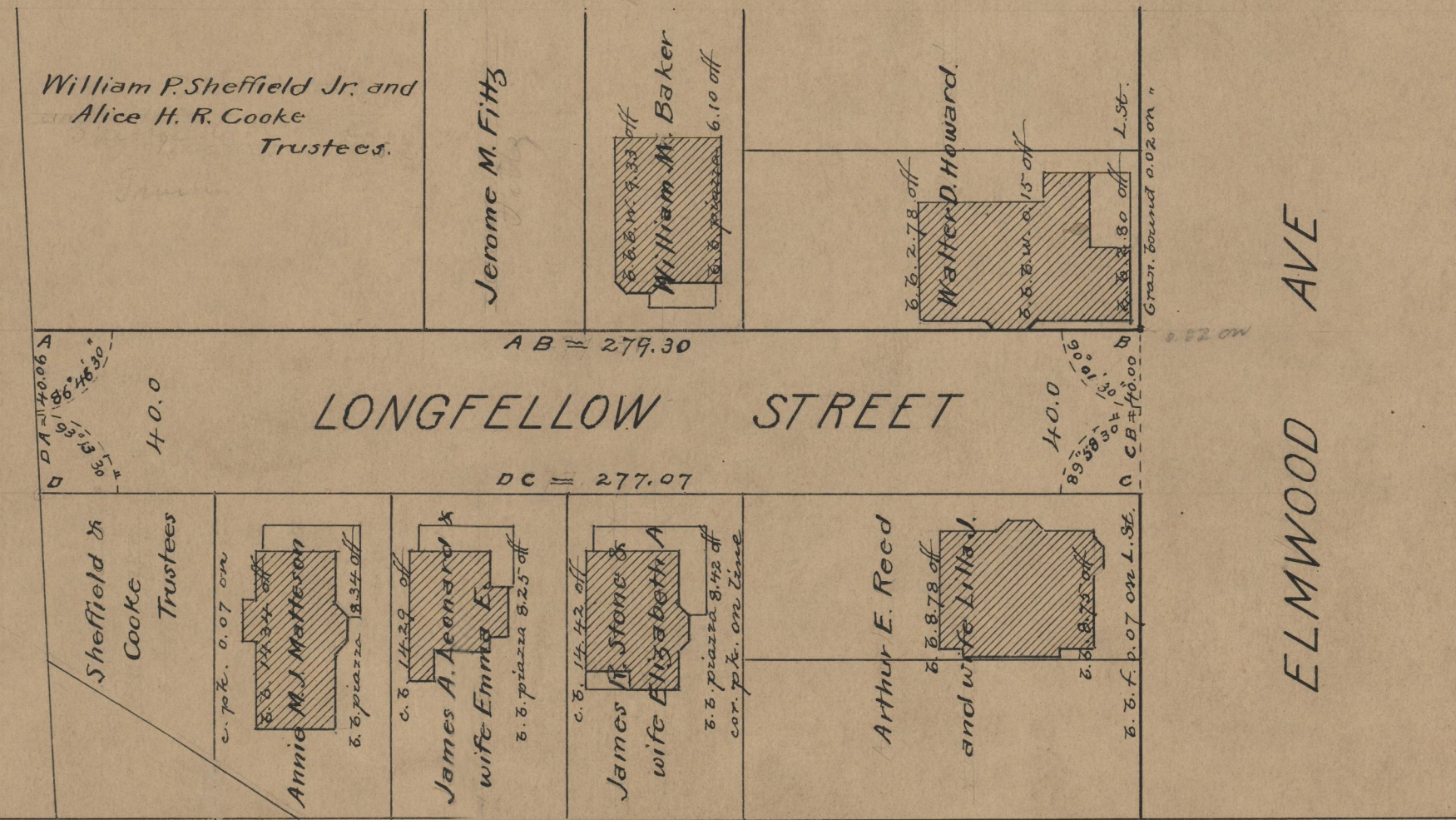

74
A-95

OFFICE No. 19891
DRAWER " 74
SHEET " A-95