

PROVIDENCE, R.I.
CITY ENGINEER'S OFFICE
STREET LINE DEPT.

Aug. 17, 1916

042166

PLAT OF A

PARCEL OF LAND

AT THE SOUTHWESTERLY CORNER
OF WATERMAN AND BENEFIT STS.

SCALE 10 FEET PER INCH.

*Declared a Public Highway
by Resolution of the
Board of Aldermen
August 3, 1916.*

18.95

Witness: -----

City Clerk.

Note, The area declared a public highway
is indicated by the letters ABC.
The lines thus fixed conform to the plan
numbered 042024 and to the deed recorded
in Deed book 558, page 422, in the Office
of the Recorder of Deeds.



93° 04' 20"
92° 32'

WATERMAN ST.

BENEFIT ST.

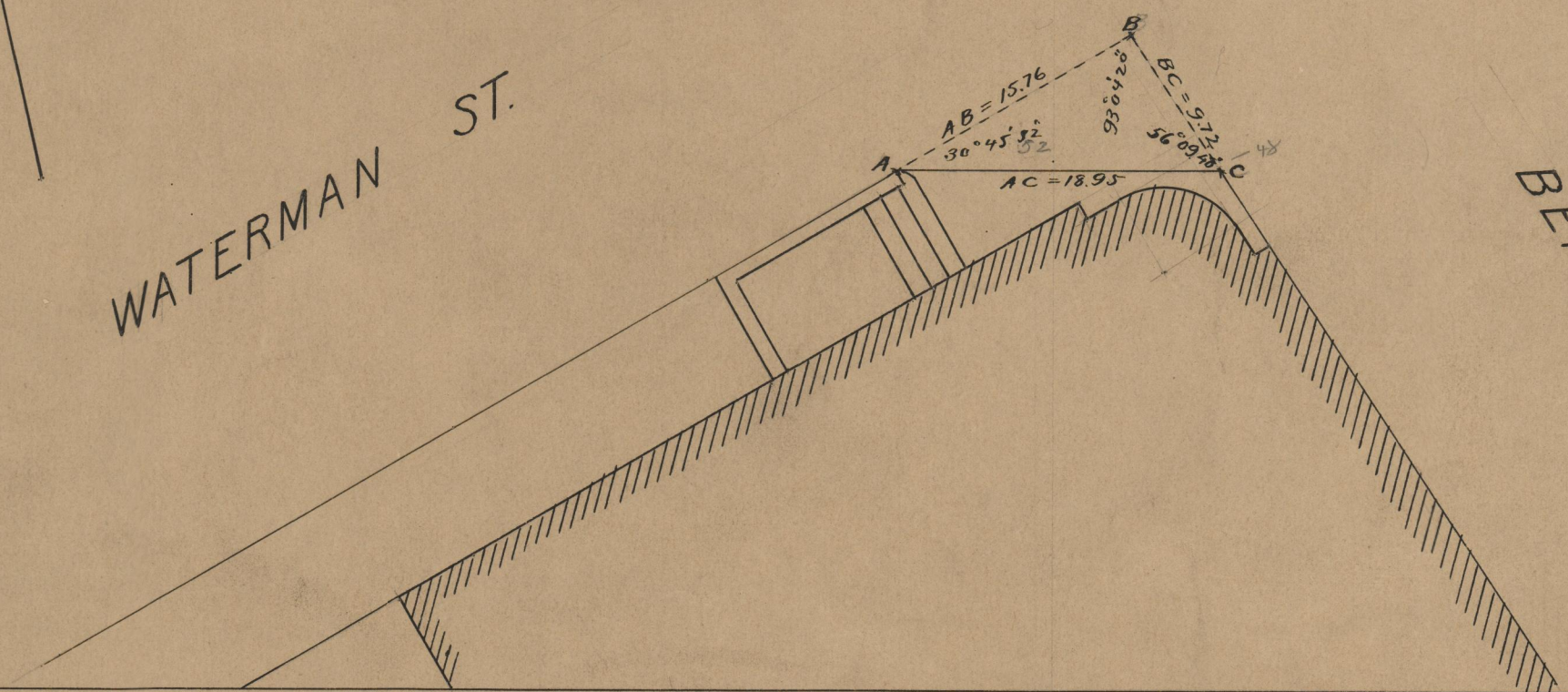

OFFICE No. 19874
DRAWER " 74
SHEET " A-91