

# PLAT OF COLE AVENUE

FROM PRESIDENT AVE. TO SESSIONS ST.

IN THREE SHEETS  
SCALE 60 FEET PER INCH.

*Declared a Public Highway  
by resolution of the  
Board of Aldermen  
October 15, 1914.*

PROVIDENCE, R.I.  
CITY ENGINEER'S OFFICE  
STREET LINE DEPT.

Nov. 12, 1914

049511

Witness.....  
City Clerk.

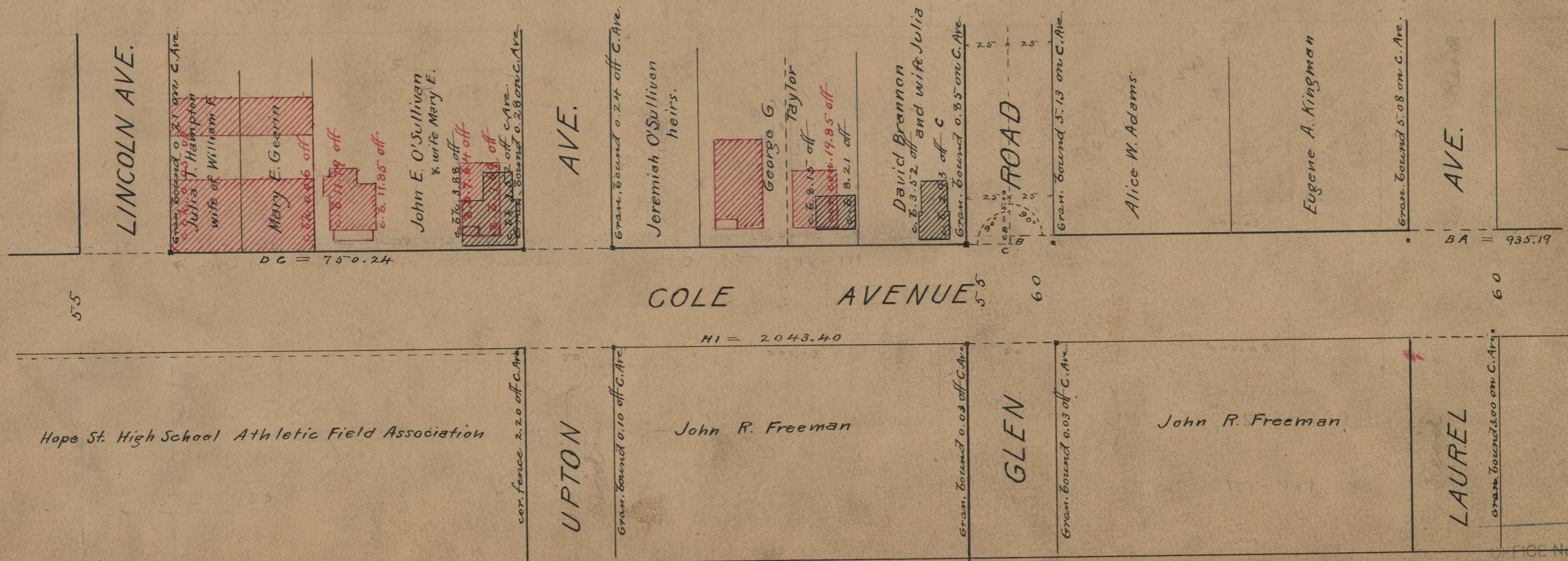
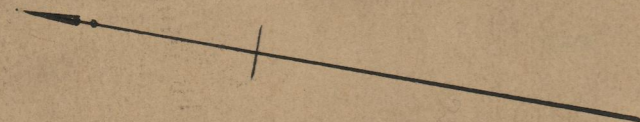

OFFICE No. 19381  
 DRAWER 74  
 SHEET A-32