

PROVIDENCE, R.I.
CITY ENGINEER'S OFFICE
STREET LINE DEPT.

Aug. 7, 1914

040275

PLAT OF GLEN ROAD

FROM WESTERLY LINE OF SLATER AVE.
TO BLACKSTONE BOULEVARD.
SCALE 50 FEET PER INCH.

DECLARED A PUBLIC HIGHWAY
BY RESOLUTION OF THE
BOARD OF ALDERMEN

May 21, 1914.
250.00

Witness, -----

City Clerk.

CHANGED TO FREEMAN PARKWAY
MARCH 18, 1937

Note, The area declared a public highway
is indicated by the letters ABCD.
The lines thus fixed conform to the deeds
recorded in Deed book 466, page 225, Deed book
497, page 161, Deed book 511, page 154, Deed book
512, page 161, and Deed book 520, page 469, in
the office of the Recorder of Deeds.

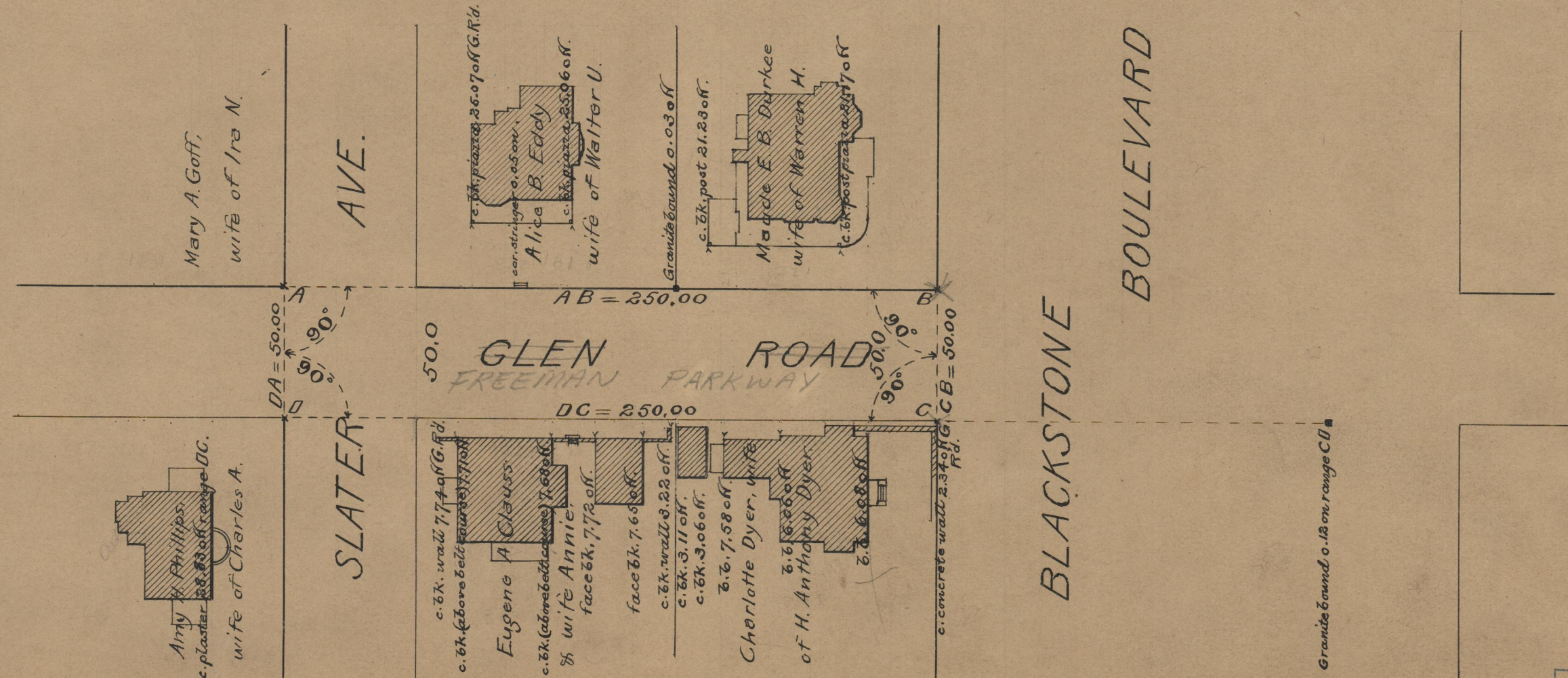

OFFICE No. 19324
DRAWER " 74
SHEET " A-14