

PLAT OF

# POMONA AVENUE

FROM CARLETON ST. TO MT. PLEASANT AVE.

SCALE 40 FEET PER INCH

Declared and established as a Public Highway by the  
Resolution of the Board of Aldermen  
August 2, 1928.

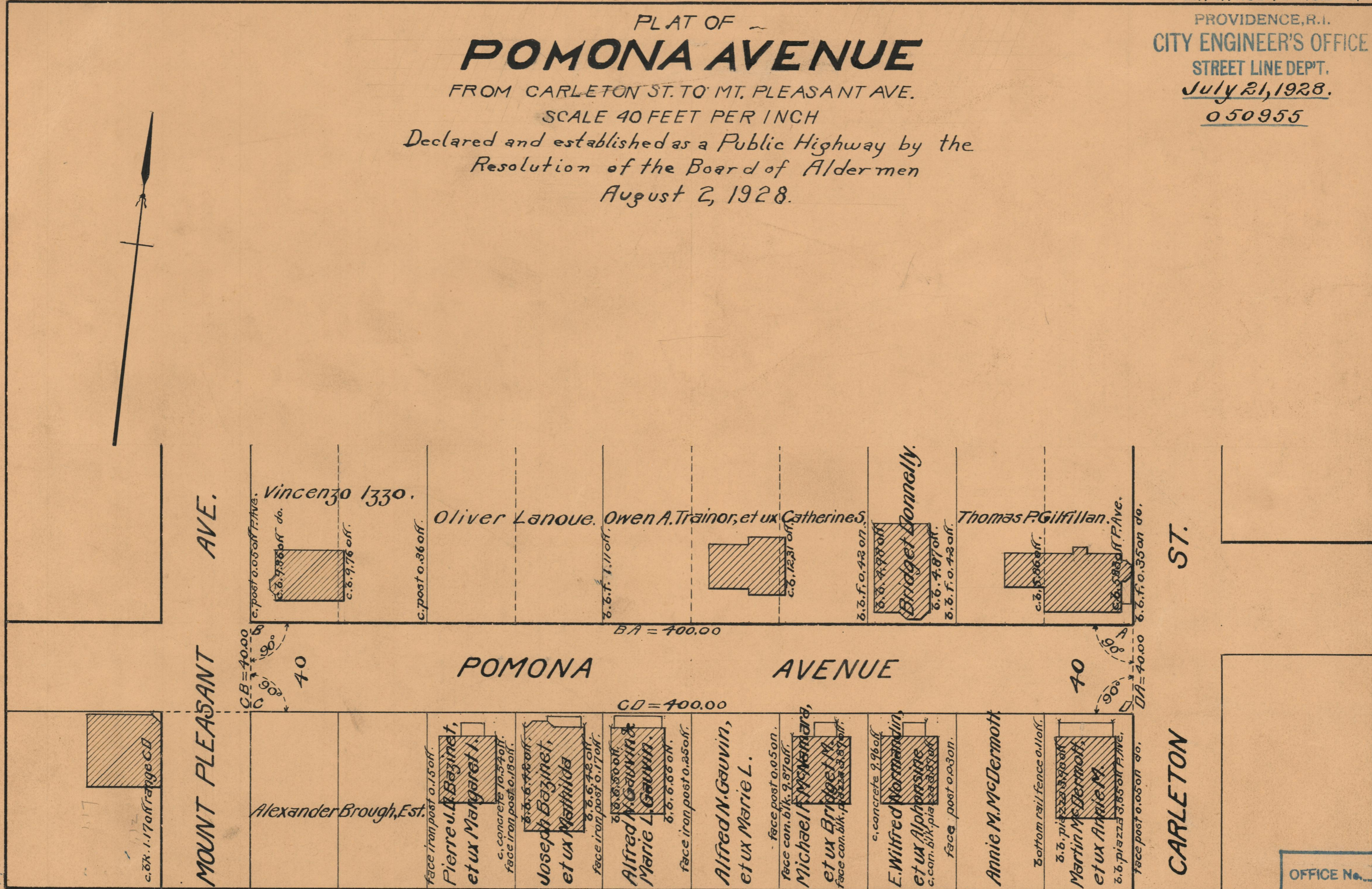
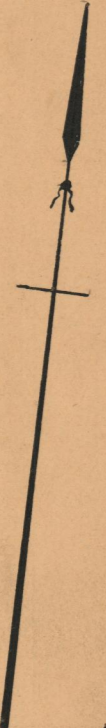

MOUNT PLEASANT AVE.

MOUNT PLEASANT AVE.

POMONA AVENUE

POMONA AVENUE

CARLETON ST.

CARLETON ST.

OFFICE No.	23961
DRAWER	73
SHEET	B-79